



DEPARTMENT OF REGULATORY AND ECONOMIC RESOURCES (RER)  
BOARD AND CODE ADMINISTRATION DIVISION

## NOTICE OF ACCEPTANCE (NOA)

MIAMI-DADE COUNTY  
PRODUCT CONTROL SECTION  
11805 SW 26 Street, Room 208  
Miami, Florida 33175-2474  
T (786) 315-2590 F (786) 315-2599

[www.miamidade.gov/building](http://www.miamidade.gov/building)

**Aldora Aluminum & Glass Products, Inc.**

**4250 Coral Ridge Drive**

**Coral Springs, FL 33065**

### SCOPE:

This NOA is being issued under the applicable rules and regulations governing the use of construction materials. The documentation submitted has been reviewed and accepted by Miami-Dade County RER - Product Control Section to be used in Miami-Dade County and other areas where allowed by the Authority Having Jurisdiction (AHJ).

This NOA shall not be valid after the expiration date stated below. The Miami-Dade County Product Control Section (In Miami-Dade County) and/ or the AHJ (in areas other than Miami-Dade County) reserve the right to have this product or material tested for quality assurance purposes. If this product or material fails to perform in the accepted manner, the manufacturer will incur the expense of such testing and the AHJ may immediately revoke, modify, or suspend the use of such product or material within their jurisdiction. RER reserves the right to revoke this acceptance if it is determined by Miami-Dade County Product Control Section that this product or material fails to meet the requirements of the applicable building code.

This product is approved as described herein, and has been designed to comply with the Florida Building Code, including the High Velocity Hurricane Zone.

### DESCRIPTION: Series "SMI-090" Aluminum Window Wall System – L.M.I.

**APPROVAL DOCUMENT:** Drawing No. **W09-24**, titled "Series SMI-090 Alum Window Wall (L.M.I.)", sheets 1, 1.1, 2, 2.1, 2.2, 3 through 12, 12.1, 13, 13.1 and 13.2 of 13, dated 04/16/09, with revision **G** dated 06/25/20, prepared by Al-Farooq Corporation, signed and sealed by Jalal Farooq, P.E., bearing the Miami-Dade County Product Control Revision stamp with the Notice of Acceptance number and expiration date by the Miami-Dade County Product Control Section.

### MISSILE IMPACT RATING: Large and Small Missile Impact Resistant

**LABELING:** Each unit shall bear a permanent label with the manufacturer's name or logo, city, state, model/series, and following statement: "Miami-Dade County Product Control Approved", unless otherwise noted herein.

**RENEWAL** of this NOA shall be considered after a renewal application has been filed and there has been no change in the applicable building code negatively affecting the performance of this product.

**TERMINATION** of this NOA will occur after the expiration date or if there has been a revision or change in the materials, use, and/ or manufacture of the product or process. Misuse of this NOA as an endorsement of any product, for sales, advertising or any other purposes shall automatically terminate this NOA. Failure to comply with any section of this NOA shall be cause for termination and removal of NOA.

**ADVERTISEMENT:** The NOA number preceded by the words Miami-Dade County, Florida, and followed by the expiration date may be displayed in advertising literature. If any portion of the NOA is displayed, then it shall be done in its entirety.

**INSPECTION:** A copy of this entire NOA shall be provided to the user by the manufacturer or its distributors and shall be available for inspection at the job site at the request of the Building Official.

This NOA **revises NOA No. 20-0128.06** and consists of this page 1 and evidence pages E-1, E-2, E-3, E-4 and E-5, as well as approval document mentioned above.

The submitted documentation was reviewed by **Manuel Perez, P.E.**

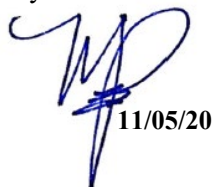

  
11/05/20

**NOA No. 20-0910.07**  
**Expiration Date: May 12, 2025**  
**Approval Date: November 12, 2020**  
**Page 1**

**Aldora Aluminum & Glass Products, Inc.**

**NOTICE OF ACCEPTANCE: EVIDENCE SUBMITTED**

**1. EVIDENCE SUBMITTED UNDER PREVIOUS NOA's**

**A. DRAWINGS**

1. Manufacturer's die drawings and sections.  
*(Submitted under NOA's No. 10-0401.03 and No. 13-1224.03)*
2. Drawing No. **W09-24**, titled "Series SMI-090 Alum Window Wall (L.M.I.)", sheets 1, 1.1, 2, 2.1, 2.2, 3 through 12, 12.1, 13, 13.1 and 13.2 of 13, dated 04/16/09, with revision **F** dated 08/21/17, prepared by Al-Farooq Corporation, signed and sealed by Javad Ahmad, P.E.  
*(Submitted under NOA No. 20-0128.06)*

**B. TESTS**

1. Test reports on: 1) Drop Load Test, (class A) per ANSI Z97.1 and per FBC (HVHZ), sections 1618.4.6.3 and 2411  
2) Safety Performance Test, per CPCS 16 CFR 1201 (Cat 11) and per FBC (HVHZ), sections 1618.4.6.3 and 2411  
along with marked-up drawings and installation diagram of a window wall system, prepared by Fenestration Testing Laboratory, Inc., Test Report No. **FTL-8812**, dated 02/16/16, signed and sealed by Idalmis Ortega, P.E.  
*(Submitted under NOA No. 17-0201.03)*
2. Test reports on: 1) Air Infiltration Test, per FBC, TAS 202-94  
2) Uniform Static Air Pressure Test, Loading per FBC, TAS 202-94  
3) Water Resistance Test, per FBC, TAS 202-94  
along with marked-up drawings and installation diagram of a window wall system, prepared by Blackwater Testing, Inc., Test Report No. **BT-ALD-15-002**, dated 06/25/15, signed and sealed by Yamil Gerardo Kuri, P. E.  
*(Submitted under NOA No. 17-0201.03)*
3. Test reports on: 1) Large Missile Impact Test per FBC, TAS 201-94  
2) Cyclic Wind Pressure Loading per FBC, TAS 203-94  
along with marked-up drawings and installation diagram of a window wall system, prepared by Blackwater Testing, Inc., Test Report No. **BT-ALD-15-004**, dated 03/25/15, signed and sealed by Yamil Gerardo Kuri, P.E.  
*(Submitted under NOA No. 17-0201.03)*
4. Test reports on: 1) Large Missile Impact Test per FBC, TAS 201-94  
2) Cyclic Wind Pressure Loading per FBC, TAS 203-94  
along with marked-up drawings and installation diagram of a window wall system, prepared by Fenestration Testing Laboratory, Inc., Test Reports No. **FTL-7857** dated 07/17/14, and **FTL-7885**, dated 03/27/15, both signed and sealed by Idalmis Ortega, P.E.  
*(Submitted under NOA No. 17-0201.03)*

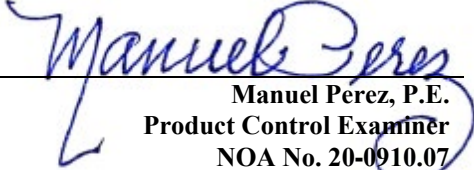
  
Manuel Perez, P.E.  
Product Control Examiner  
NOA No. 20-0910.07  
Expiration Date: May 12, 2025  
Approval Date: November 12, 2020

**Aldora Aluminum & Glass Products, Inc.**

**NOTICE OF ACCEPTANCE: EVIDENCE SUBMITTED**

**1. EVIDENCE SUBMITTED UNDER PREVIOUS NOA's (CONTINUED)**

**B. TESTS (CONTINUED)**

5. Test reports on: 1) Uniform Static Air Pressure Test Loading per FBC, TAS 202-94 along with marked-up drawings and installation diagram of a window wall system, prepared by Architectural Testing, Inc., Test Report No. **ATI-D5598.01-450-18**, dated 08/05/14, signed and sealed by Shawn G. Collins, P.E.  
**(Submitted under NOA No. 17-0201.03)**
6. Test reports on: 1) Air Infiltration Test per FBC, TAS 202-94  
2) Uniform Static Air Pressure Test Loading per FBC, TAS 202-94  
3) Water Resistance Test per FBC, TAS 202-94  
along with marked-up drawings and installation diagram of an aluminum window wall system, prepared by Fenestration Testing Laboratory, Inc., Test Report No. **FTL-7336**, dated 05/22/13, signed and sealed by Jorge A. Naya, P.E.  
**(Submitted under NOA No. 13-1224.03)**
7. Test reports on: 1) Air Infiltration Test per FBC, TAS 202-94  
2) Uniform Static Air Pressure Test Loading per FBC, TAS 202-94  
3) Water Resistance Test per FBC, TAS 202-94  
4) Large Missile Impact Test per FBC, TAS 201-94  
5) Cyclic Wind Pressure Loading per FBC, TAS 203-94  
6) Forced Entry Test, per FBC 2411.3.2.1 (b) and TAS 202-94  
along with marked-up drawings and installation diagram of an aluminum window wall system, prepared by Fenestration Testing Laboratory, Inc., Test Report No. **FTL-5746** dated 01/27/09, signed and sealed by Carlos S. Rionda, P.E.  
**(Submitted under NOA No. 10-0128.03)**

**C. CALCULATIONS**

1. Anchor verification calculations and structural analysis, complying with **FBC 5<sup>th</sup> Edition (2014)**, dated 01/26/17 and with **FBC 6<sup>th</sup> Edition (2017)**, dated 10/17/17, prepared by Al-Farooq Corporation, signed and sealed by Javad Ahmad, P.E.  
**(Submitted under NOA No. 17-0201.03)**
2. Glazing complies with **ASTM E1300-09**.

**D. QUALITY ASSURANCE**

1. Miami-Dade Department of Regulatory and Economic Resources (RER)

**E. MATERIAL CERTIFICATIONS**

1. Notice of Acceptance No. **18-0301.05** issued to **Eastman Chemical Company (MA)** for their "**Saflex HP Clear or Color Glass Interlayers**" dated 05/10/18, expiring on 04/14/23.

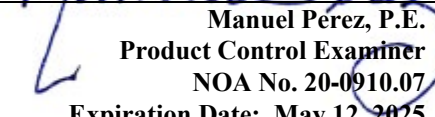
  
Manuel Perez, P.E.  
Product Control Examiner  
NOA No. 20-0910.07  
Expiration Date: May 12, 2025  
Approval Date: November 12, 2020

**Aldora Aluminum & Glass Products, Inc.**

**NOTICE OF ACCEPTANCE: EVIDENCE SUBMITTED**

**1. EVIDENCE SUBMITTED UNDER PREVIOUS NOA's (CONTINUED)**

**E. MATERIAL CERTIFICATIONS (CONTINUED)**

2. Notice of Acceptance No. **19-0221.01** issued to **Allnex USA, Inc.** for their “**Uveköl® S Laminated Glass Interlayer**”, dated 03/28/19, expiring on 02/08/24.
3. Notice of Acceptance No. **17-0808.02** issued to **Kuraray America, Inc.** for their “**SentryGlas® (Clear and White) Glass Interlayers**” dated 12/28/17, expiring on 07/04/23.

**F. STATEMENTS**

1. Statement letter of conformance, complying with **FBC 5<sup>th</sup> Edition (2014)** and with **FBC 6<sup>th</sup> Edition (2017)**, and of no financial interest, dated September 28, 2017, issued by Al-Farooq Corporation, signed and sealed by Javad Ahmad, P.E.  
*(Submitted under NOA No. 17-0201.03)*
2. Laboratory compliance letter for Test Reports No. **FTL-8812**, dated 02/16/16, **FTL-7885**, dated 03/27/15 and **FTL-7857**, dated 07/17/14, all issued by Fenestration Testing Laboratory, Inc., all signed and sealed by Idalmis Ortega, P.E.  
*(Submitted under NOA No. 17-0201.03)*
3. Laboratory compliance letter for Test Reports No. **BT-ALD-15-002**, dated 06/25/15 and **BT-ALD-15-004**, dated 03/25/15, both issued by Blackwater Testing, Inc., both signed and sealed by Yamil Gerardo Kuri, P.E.  
*(Submitted under NOA No. 17-0201.03)*
4. Laboratory compliance letter for Test Report No. **ATI-D5598.01-450-18**, issued by Architectural Testing, Inc., dated 08/05/14, signed and sealed by Shawn G. Collins, P.E.  
*(Submitted under NOA No. 17-0201.03)*
5. Department of State Certification of **ALDORA ALUMINUM & GLASS PRODUCTS, INC.** as a foreign profit corporation, active and organized under the laws of the State of Florida, dated March 10, 2015 and filed by the Secretary of State.  
*(Submitted under NOA No. 13-1224.03)*
6. Statement letter dated 08/21/13, issued by Aldora Aluminum & Glass Products, Inc. of legally purchase of asset and rights of **NOA No. 12-0731.06** from Pande Pane, LLC dba SMI Aluminum System, LLC and requesting that said NOA be issued under their name, signed by Manny Valladares, for and on behalf of Aldora Aluminum & Glass Products, Inc.  
*(Submitted under NOA No. 13-1224.03)*
7. Letter from owners of existing NOA stating that they have sold all assets to the applicant, that they no longer manufacture the product and relinquish their rights to the current **NOA No. 12-0731.06**, dated 08/21/13, signed by Mr. Manny Valladares, for and on behalf of Pande Pane, LLC dba SMI Aluminum Systems, LLC.  
*(Submitted under NOA No. 13-1224.03)*

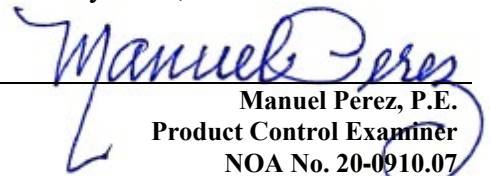
  
Manuel Perez, P.E.  
Product Control Examiner  
NOA No. 20-0910.07  
Expiration Date: May 12, 2025  
Approval Date: November 12, 2020

**Aldora Aluminum & Glass Products, Inc.**

**NOTICE OF ACCEPTANCE: EVIDENCE SUBMITTED**

**1. EVIDENCE SUBMITTED UNDER PREVIOUS NOA's (CONTINUED)**

**F. STATEMENTS (CONTINUED)**

8. Assignment & Assumption agreement dated July 26, 2013 between Aldora Holdings LLC, SMI Aluminum Systems, LLC, Architectural Glass Products, LLC (each an "Assignor" and collectively, the "Assignors") and Aldora Holdco, Inc. (the "Assignee") signed by Leon Silverstein, Aldora Holdings LLC manager; Leon Silverstein, SMI Aluminum Systems, LLC, manager; Leon Silverstein, Architectural Glass Products, LLC manager and Scott Hauncher, VP Aldora Holdco, Inc.  
*(Submitted under NOA No. 13-1224.03)*
9. Bill of Sale dated July 26, 2013, delivered by Aldora Holdco, Inc. transferring assets to Aldora Aluminum & Glass Products, Inc., signed by Mr. Scott Hauncher, Vice President, Aldora Holdco, Inc.  
*(Submitted under NOA No. 13-1224.03)*
10. Department of State Certification of **ALDORA ALUMINUM & GLASS PRODUCTS, INC.** as a foreign profit corporation, active and organized under the laws of the State of Delaware, dated 07/18/13 and signed by Jeffrey W. Bullock, Secretary of State.  
*(Submitted under NOA No. 13-1224.03)*
11. Department of State Certification of **ALDORA ALUMINUM & GLASS PRODUCTS, INC.** as a foreign profit corporation, active and organized under the laws of the State of Florida, dated 07/20/13 and signed by T. Burgh, Secretary of State.  
*(Submitted under NOA No. 13-1224.03)*
12. Laboratory compliance letter for Test Report No. **FTL-7336**, issued by Fenestration Testing Laboratory, Inc., dated 05/22/13, signed and sealed by Jorge A. Naya, P.E.  
*(Submitted under NOA No. 13-1224.03)*
13. Laboratory compliance letter for Test Report No. **FTL-5746**, issued by Fenestration Testing Laboratory, Inc., dated 01/27/09, signed and sealed by Carlos S. Rionda P.E.  
*(Submitted under NOA No. 10-0128.03)*
14. Proposal No. **08-0557** issued by the Product Control, dated 06/18/08, signed by Manuel Perez, P.E.  
*(Submitted under NOA No. 10-0128.03)*

**G. OTHERS**

1. Notice of Acceptance No. **17-0201.03**, issued to Aldora Aluminum & Glass Products, Inc. for their Series "SMI-090" Aluminum Window Wall System – L.M.I., approved on 11/09/17 and expiring on 05/12/20.

  
Manuel Perez, P.E.  
Product Control Examiner  
NOA No. 20-0910.07  
Expiration Date: May 12, 2025  
Approval Date: November 12, 2020



**Aldora Aluminum & Glass Products, Inc.**

**NOTICE OF ACCEPTANCE: EVIDENCE SUBMITTED**

**2. NEW EVIDENCE SUBMITTED**

**A. DRAWINGS**

1. Drawing No. **W09-24**, titled “Series SMI-090 Alum Window Wall (L.M.I.)”, sheets 1, 1.1, 2, 2.1, 2.2, 3 through 12, 12.1, 13, 13.1 and 13.2 of 13, dated 04/16/09, with revision **G** dated 06/25/20, prepared by Al-Farooq Corporation, signed and sealed by Jalal Farooq, P.E.

**B. TESTS**

1. None.

**C. CALCULATIONS**

1. Anchor verification calculations and structural analysis, complying with **FBC 5<sup>th</sup> Edition (2014)**, dated 01/26/17, with **FBC 6<sup>th</sup> Edition (2017)**, dated 10/17/17 and updated on 07/15/20 to comply with **FBC 7<sup>th</sup> Edition (2020)**, prepared by Al-Farooq Corporation, signed and sealed by Jalal Farooq, P.E.
2. Glazing complies with **ASTM E1300-09**

**D. QUALITY ASSURANCE**

1. Miami-Dade Department of Regulatory and Economic Resources (RER)

**E. MATERIAL CERTIFICATIONS**

1. Notice of Acceptance No. **20-0622.02** issued to **Eastman Chemical Company (MA)** for their “**Saflex HP Clear or Color Glass Interlayers**” dated 08/06/20, expiring on 04/14/23.
2. Notice of Acceptance No. **19-0221.01** issued to **Allnex USA, Inc.** for their “**Uvekool® S Laminated Glass Interlayer**”, dated 03/28/19, expiring on 02/08/24.
3. Notice of Acceptance No. **18-0725.11** issued to **Kuraray America, Inc.** for their “**Kuraray SentryGlas® Xtra™ (SGX™) Clear Glass Interlayer**” dated 05/23/19, expiring on 05/23/24.

**F. STATEMENTS**

1. Statement letter of conformance, complying with **FBC 6<sup>th</sup> Edition (2017)**, with **FBC 7<sup>th</sup> Edition (2020)** and of no financial interest, dated July 15, 2020, issued by Al-Farooq Corporation, signed and sealed by Jalal Farooq, P.E.

**G. OTHERS**

1. Notice of Acceptance No. **20-0128.06**, issued to Aldora Aluminum & Glass Products, Inc. for their Series “SMI-090” Aluminum Window Wall System – L.M.I., approved on 04/30/20 and expiring on 05/12/25.

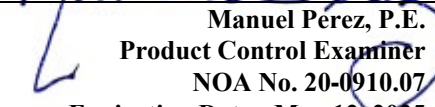
  
Manuel Perez, P.E.  
Product Control Examiner  
NOA No. 20-0910.07  
Expiration Date: May 12, 2025  
Approval Date: November 12, 2020

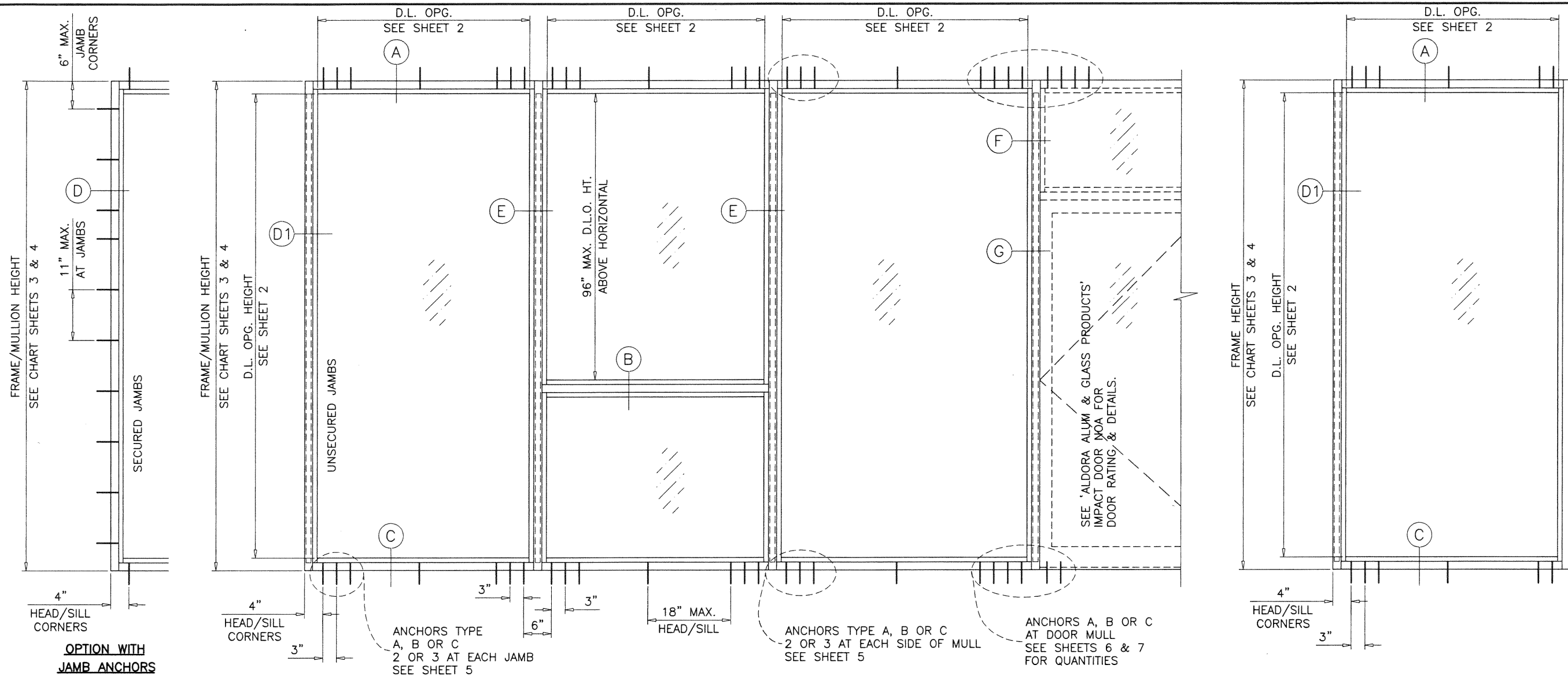

TYPICAL ELEVATIONS

## SERIES SMI-090 ALUMINUM WINDOW WALL

THIS SYSTEM MAY BE USED IN CONJUNCTION WITH MIAMI-DADE COUNTY APPR'D LARGE MISSILE IMPACT RESISTANT DOORS. LOWER DESIGN PRESSURE FROM STOREFRONT OR DOOR APPROVAL WILL APPLY TO ENTIRE SYSTEM.

THIS PRODUCT HAS BEEN DESIGNED AND TESTED TO COMPLY WITH THE REQUIREMENTS OF THE 2017 (6TH EDITION)/2020 (7TH EDITION) FLORIDA BUILDING CODE INCLUDING HIGH VELOCITY HURRICANE ZONE (HVHZ).

1BY OR 2BY WOOD BUCKS & BUCK FASTENERS BY OTHERS, MUST BE DESIGNED AND INSTALLED ADEQUATELY TO TRANSFER APPLIED PRODUCT LOADS TO THE BUILDING STRUCTURE.

ANCHORS SHALL BE CORROSION RESISTANT, SPACED AS SHOWN ON DETAILS AND INSTALLED PER MANUF'S INSTRUCTIONS. SPECIFIED EMBEDMENT TO BASE MATERIAL SHALL BE BEYOND WALL DRESSING OR STUCCO.

A LOAD DURATION INCREASE IS USED IN DESIGN OF ANCHORS INTO WOOD ONLY.

ALL SHIMS TO BE HIGH IMPACT, NON-METALLIC AND NON-COMPRESSIBLE.

MATERIALS INCLUDING BUT NOT LIMITED TO STEEL/METAL SCREWS, THAT COME INTO CONTACT WITH OTHER DISSIMILAR MATERIALS SHALL MEET THE REQUIREMENTS OF THE 2017/2020 FLORIDA BLDG. CODE & ADOPTED STANDARDS.

THIS PRODUCT APPROVAL IS GENERIC AND DOES NOT PROVIDE INFORMATION FOR A SITE SPECIFIC PROJECT, I.E. LIFE SAFETY OF THIS PRODUCT, ADEQUACY OF STRUCTURE RECEIVING THIS PRODUCT AND SEALING AROUND OPENING FOR WATER INFILTRATION RESISTANCE ETC. CONDITIONS NOT SHOWN IN THIS DRAWING ARE TO BE ANALYZED SEPARATELY, AND TO BE REVIEWED BY BUILDING OFFICIAL.

DESIGN LOADS SHOWN ARE BASED ON 'ALLOWABLE STRESS DESIGN (ASD)'.

## INSTRUCTIONS:

USE CHARTS AS FOLLOWS.

- STEP 1** DETERMINE DESIGN WIND LOAD REQUIREMENT BASED ON WIND VELOCITY, BLDG. HEIGHT, WIND ZONE USING APPLICABLE ASCE 7 STANDARD.
- STEP 2** SEE CHARTS ON SHEET 2 THRU 2.3 FOR DESIGN LOAD CAPACITY OF DESIRED GLASS SIZE.
- STEP 3** CHECK MULLION CAPACITY FOR A GIVEN SPACING AND HEIGHT USING CHARTS ON SHEET 3 & 4 FOR STOREFRONT MULLION AND SHEET 6 & 7 FOR DOOR MULLION. THE CAPACITY SHOULD EXCEED THE DESIGN LOAD.
- STEP 4** USING CHART ON SHEETS 5 SELECT ANCHOR OPTION WITH DESIGN RATING MORE THAN DESIGN LOAD SPECIFIED IN STEP 1 ABOVE.
- STEP 5** THE LOWEST VALUE RESULTING FROM STEPS 2, 3 AND 4 SHALL APPLY TO ENTIRE SYSTEM.

## SINGLE 'O' PANEL:

FRAME WIDTH = D.L.O. WIDTH + 5.500"  
 FRAME HEIGHT = D.L.O. HEIGHT + 5.500"  
 FOR ANCHORED JAMBS MAX. SIZES USE GLASS CHART ON SHEET 2.  
 FOR UNANCHORED JAMB FRAME USE CHARTS ON SHEETS 3 & 4.

PRODUCT COMPLIES WITH REQUIREMENTS OF ANSI Z97.1. WITH 9/16" LAMINATED GLASS WITH .10" UVEKOL S INTERLAYER AND MAX. D.L.O. DIMENSIONS OF 30-1/4" X 70-1/2"

THIS SYSTEM IS RATED FOR LARGE & SMALL MISSILE IMPACT. SHUTTERS ARE NOT REQUIRED.

**PRODUCT REVISED**  
 as complying with the Florida Building Code

NOA-No. **20-0910.07**

Expiration Date: **05/12/2025**

By: *Manuel Perez*  
 Miami-Dade Product Control

OCT 28 2020

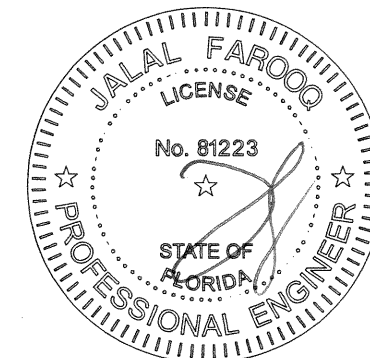

**AL-FAROOQ CORPORATION**  
 ENGINEERS & PRODUCT DEVELOPMENT  
 9360 SUNSET DRIVE, SUITE 220  
 MIAMI, FLORIDA 33173 (C.A.N. 3538)  
 TEL. (305) 264-8100 FAX. (305) 262-6978  
 COMP-ANL\W09-24SM

SERIES SMI-090 ALUM WINDOW WALL (L.M.I.)  
**Aldora Aluminum & Glass Products Inc.**  
 4250 Coral Ridge Drive, Suite 101  
 Coral Springs, FL. 33065  
 Tel. (954) 784-6900 Fax. (954) 784-6901

no	date	by	description
C	08.12.13		MANUF. NAME REV.
D	03.05.14		NO CHANGE THIS SHEET
E	01.11.17		GENERAL REVISION
F	08.21.17		REV. PER RER COMMENTS
G	08.25.20		UPDATED TO 2020 FBC

date: 04-16-09  
 scale: 1/2"=1'-0"  
 dr. by: TARIQ  
 chk. by:

drawing no.

**W09-24**

sheet 1 of 13

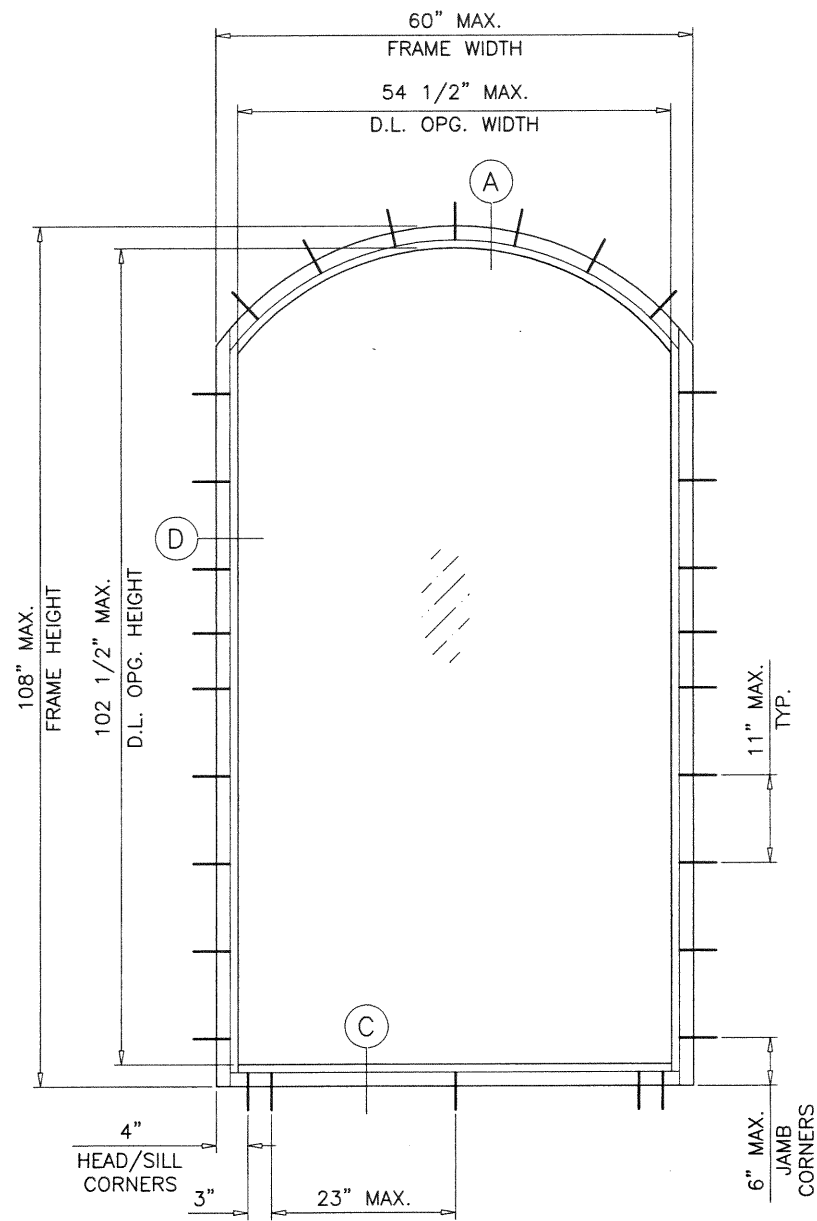
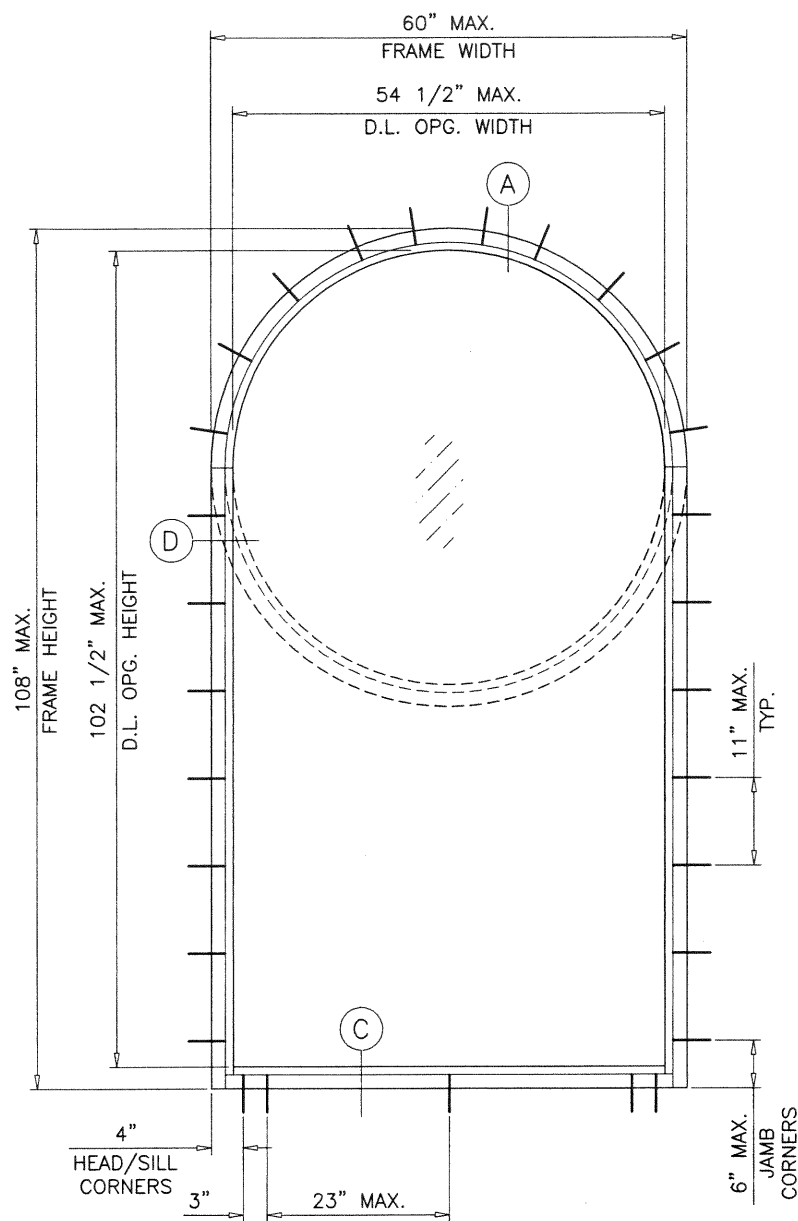

GLASS TYPE 'B'  
 MAXIMUM DESIGN LOAD RATING = + 80.0 PSF  
 (FOR SHAPES AND SIZE - 100.0 PSF  
 SHOWN ON THIS SHEET ONLY)

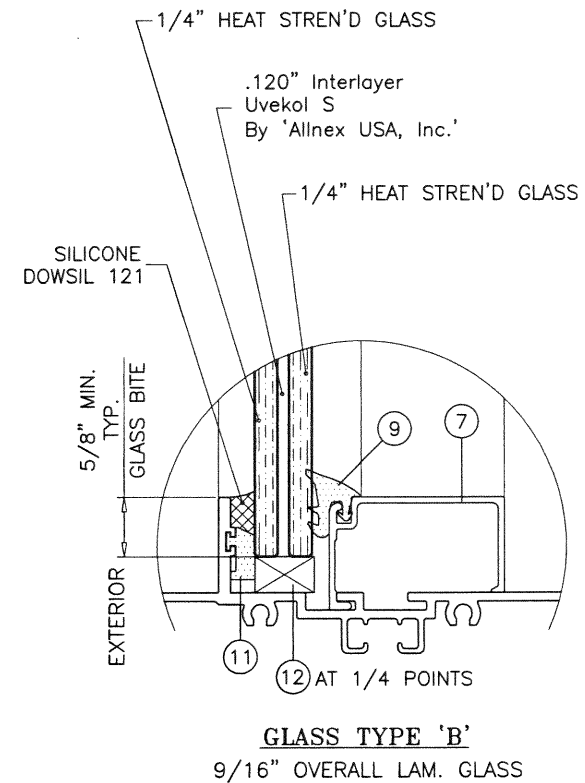

GLASS TYPE 'B'  
 9/16" OVERALL LAM. GLASS

**PRODUCT REVISED**  
 as complying with the Florida  
 Building Code  
 NOA-No. **20-0910.07**  
 Expiration Date: **05/12/2025**  
 By: *Manuel Perez*  
 Miami-Dade Product Control

OCT 28 2020

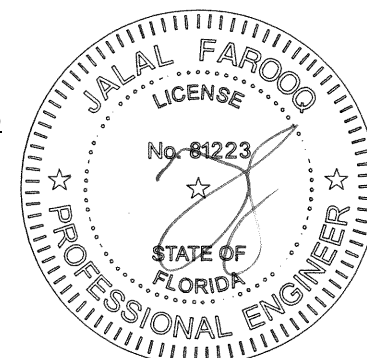

**AL-FAROOQ CORPORATION**  
 ENGINEERS & PRODUCT DEVELOPMENT  
 9360 SUNSET DRIVE, SUITE 220 (C.A.N. 3538)  
 MIAMI, FLORIDA 33173  
 TEL. (305) 264-8100 FAX. (305) 262-6978  
 COMP-ANL\W09-24SM

SERIES SMI-090 ALUM WINDOW WALL (L.M.I.)  
**Aldora Aluminum & Glass Products Inc.**  
 4250 Coral Ridge Drive, Suite 101  
 Coral Springs, FL 33065  
 Tel. (954) 784-6900 Fax. (954) 784-6901

revisions:		
no	date	by description
E	01.11.17	GENERAL REVISION
F	08.21.17	REV. PER PER COMMENTS
G	06.25.20	UPDATED TO 2020 FBC

date: 04-16-09  
 scale: 1/2"=1'-0"  
 dr. by: TARIQ  
 chk. by:

drawing no.  
**W09-24**  
 sheet 1.1 of 13





GLASS LOAD CAPACITY - PSF		
NOMINAL DIMS.		GLASS TYPES 'C' & 'C1'
D.L.O. WIDTH	D.L.O. HEIGHT	EXT. (+) INT. (-)
30"	66-1/2"	80.0
36"		80.0
42"		80.0
48"		80.0
54"		80.0
60"		80.0
66-1/2"		80.0
30"	72-1/2"	80.0
36"		80.0
42"		80.0
48"		80.0
54"		80.0
60"		80.0
66"		80.0
30"	78-1/2"	80.0
36"		80.0
42"		80.0
48"		80.0
54"		80.0
60"		80.0
30"	84-1/2"	80.0
36"		80.0
42"		80.0
48"		80.0
54"		80.0
60"		80.0
30"	90-1/2"	80.0
36"		80.0
42"		80.0
48"		80.0
54"		80.0
60"		80.0

INTERPOLATION BETWEEN WIDTHS OR HEIGHTS ALLOWED.

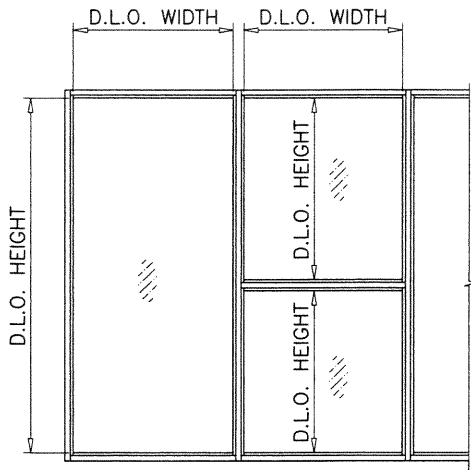

NOTE:  
GLASS CAPACITIES ON THIS SHEET ARE  
BASED ON ASTM E1300-09 (3 SEC. GUSTS).

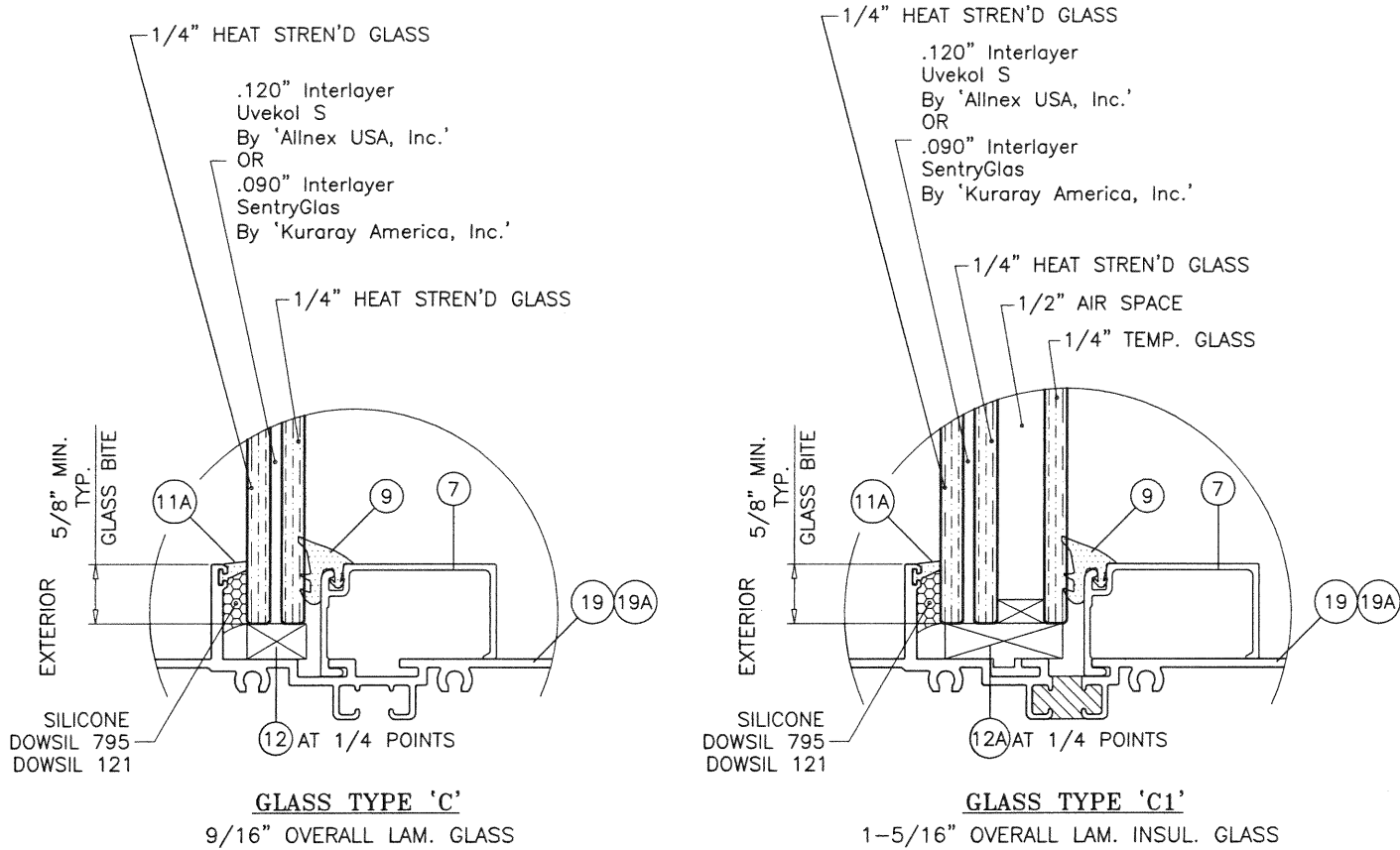

### GLAZING OPTIONS

INTERIOR GLAZED

1/2" AIR SPACE CONSISTING OF:  
SPACER:  
'PROFIGLASS' ALUMINUM SPACER  
BY 'RAMAPO USA'  
PERIMETER SEALANT:  
SILICONE  
DOWSIL CWS  
DOWSIL 899  
GE 2000  
PECORA 895

NOTE:  
WINDOW WALL FRAMES AT INSULATED GLASS OPTION  
MAY BE WITH OR WITHOUT THERMAL BREAK.

**PRODUCT REVISED**  
as complying with the Florida  
Building Code  
NOA-No. **20-0910.07**  
Expiration Date: **05/12/2025**  
By: *Manuel Perez*  
Miami-Dade Product Control

OCT 28 2020

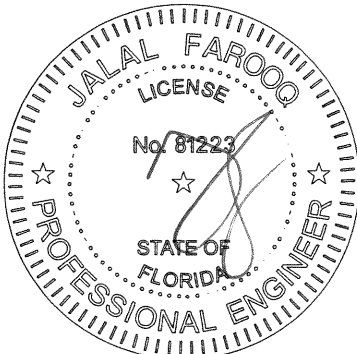

**af c**  
**AL-FAROOQ CORPORATION**  
ENGINEERS & PRODUCT DEVELOPMENT  
9360 SUNSET DRIVE, SUITE 220  
MIAMI, FLORIDA 33173 (C.A.N. 3538)  
TEL. (305) 264-8100 FAX. (305) 262-6978  
COMP-ANL\W09-24SM

SERIES SMI-090 ALUM WINDOW WALL (L.M.I.)  
**Adora Aluminum & Glass Products Inc.**  
4250 Coral Ridge Drive, Suite 101  
Coral Springs, FL. 33065  
Tel. (954) 784-6900 Fax. (954) 784-6901

revisions:	no	date	by	description
	E	01.11.17		GENERAL REVISION
	F	08.21.17		REV. PER RER COMMENTS
	G	06.25.20		UPDATED TO 2020 FBC

date: 04-16-09  
scale: 1/2" = 1"  
dr. by: TARIQ  
chk. by:

drawing no.  
**W09-24**  
sheet 2.1 of 13

GLASS



GLASS LOAD CAPACITY - PSF			
NOMINAL DIMS.		GLASS TYPES 'D' & 'D1'	
D.L.O. WIDTH	D.L.O. HEIGHT	EXT. (+)	INT. (-)
30"	66-1/2"	70.0	75.0
36"		70.0	75.0
42"		70.0	75.0
48"		70.0	75.0
54"		70.0	75.0
60"		70.0	75.0
66-1/2"		70.0	75.0
30"	72-1/2"	70.0	75.0
36"		70.0	75.0
42"		70.0	75.0
48"		70.0	75.0
54"		70.0	75.0
60"		70.0	75.0
66"		70.0	75.0
30"	78-1/2"	70.0	75.0
36"		70.0	75.0
42"		70.0	75.0
48"		70.0	75.0
54"		70.0	75.0
60"		70.0	75.0
30"	84-1/2"	70.0	75.0
36"		70.0	75.0
42"		70.0	75.0
48"		70.0	75.0
54"		70.0	75.0
60"		70.0	75.0
30"	90-1/2"	70.0	75.0
36"		70.0	75.0
42"		70.0	75.0
48"		70.0	75.0
54"		70.0	75.0
60"		70.0	75.0
30"	96-1/2"	70.0	75.0
36"		70.0	75.0
42"		70.0	75.0
48"		70.0	75.0
54"		70.0	75.0
60"		70.0	75.0
30"	102-1/2"	70.0	75.0
36"		70.0	75.0
42"		70.0	75.0
48"		70.0	75.0
54"		70.0	75.0
60"		70.0	75.0
30"	108"	70.0	75.0
36"		70.0	75.0
42"		70.0	75.0
44-1/4"		70.0	75.0
30"	114"	70.0	75.0
36"		70.0	75.0
42"		70.0	75.0
44-1/4"		70.0	75.0
30"	114-1/2"	70.0	75.0
36"		70.0	75.0
42"		70.0	75.0
44-1/4"		70.0	75.0

INTERPOLATION BETWEEN WIDTHS OR HEIGHTS ALLOWED.

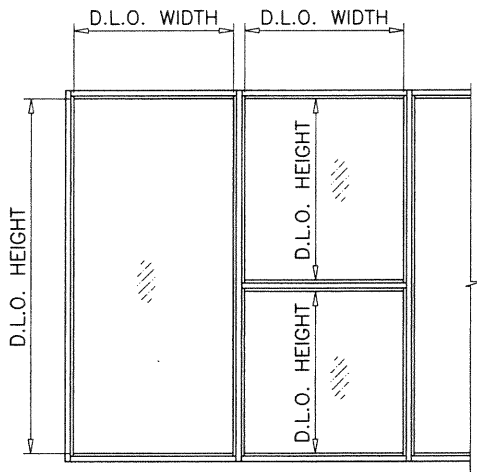

NOTE:  
GLASS CAPACITIES ON THIS SHEET ARE  
BASED ON ASTM E1300-09 (3 SEC. GUSTS).

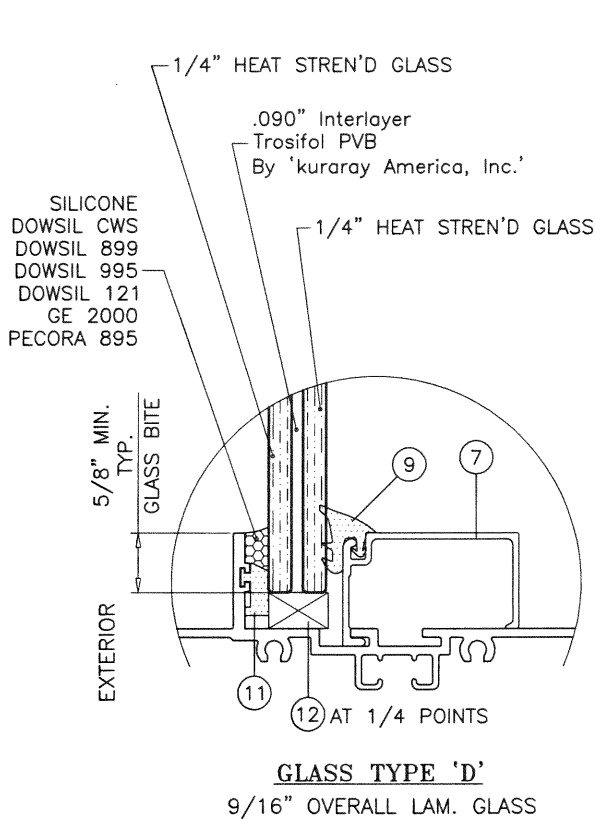

GLASS TYPE 'D'  
9/16" OVERALL LAM. GLASS

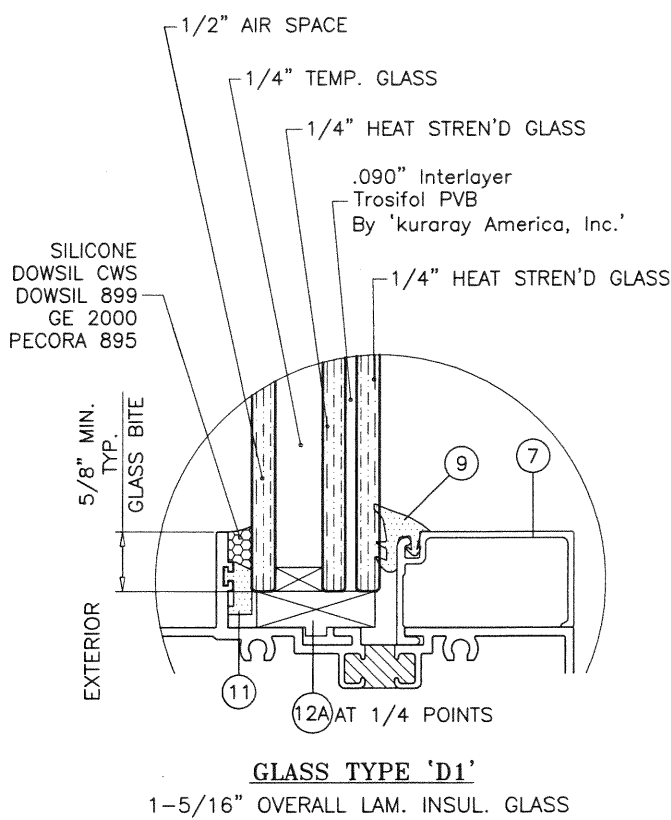

GLASS TYPE 'D1'  
1-5/16" OVERALL LAM. INSUL. GLASS

GLAZING OPTIONS  
INTERIOR GLAZED

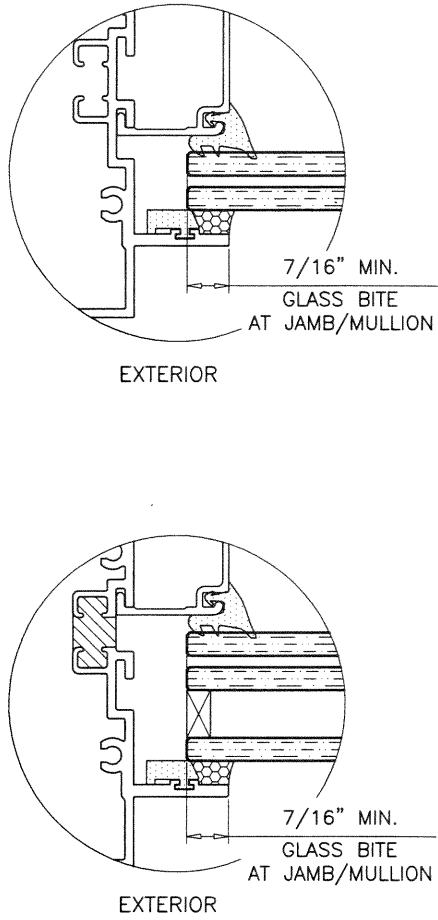

1/2" AIR SPACE CONSISTING OF:  
SPACER:  
'PROFIGLASS' ALUMINUM SPACER  
BY 'RAMAPO USA'  
PERIMETER SEALANT:  
SILICONE  
DOWSIL CWS  
DOWSIL 899  
GE 2000  
PECORA 895

PRODUCT REVISED  
as complying with the Florida  
Building Code  
NOA-No. 20-0910.07  
Expiration Date: 05/12/2025  
By: Manuel Fern  
Miami-Dade Product Control

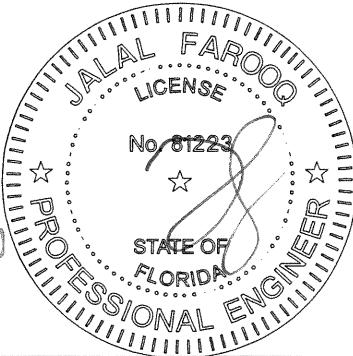

**AL-FAROOQ CORPORATION**  
ENGINEERS & PRODUCT DEVELOPMENT  
9360 SUNSET DRIVE, SUITE 220  
MIAMI, FLORIDA 33173  
TEL. (305) 264-8100 FAX. (305) 262-6978

SERIES SMI-090 ALUM WINDOW WALL (L.M.I.)  
**Aldora Aluminum & Glass Products Inc.**  
4250 Coral Ridge Drive, Suite 101  
Coral Springs, FL. 33065  
Tel. (954) 784-6900 Fax. (954) 784-6901

no	date	by	description	GENERAL REVISION	REV. PER PER COMMENTS	UPDATED TO 2020 FBC
				E 01.11.17		
				F 08.21.17		
				G 06.25.20		

date: 04-16-09  
scale: 1/2" = 1"  
dr. by: TARIQ  
chk. by:

drawing no.  
**W09-24**  
sheet 2.2 of 13

DESIGN LOAD CAPACITY - PSF JAMB/MULLION WITHOUT INTERMEDIATE HORIZONTALS				
NOMINAL DIMS.		JAMB 'J1'	JAMB 'J2'	JAMB 'J3/J4'
		MULLION 'M1'	MULLION 'M2'	MULL 'M3/M4'
WIDTH (W)	FRAME HEIGHT	EXT. (+) INT. (-)	EXT. (+) INT. (-)	EXT. (+) INT. (-)
30"	78"	80.0	90.0	90.0
36"		80.0	90.0	90.0
42"		80.0	90.0	90.0
48"		80.0	90.0	90.0
54"		80.0	90.0	90.0
60"		80.0	90.0	90.0
30"	84"	80.0	90.0	90.0
36"		80.0	90.0	90.0
42"		80.0	90.0	90.0
48"		80.0	90.0	90.0
54"		73.6	90.0	90.0
60"		-	90.0	90.0
30"	90"	80.0	90.0	90.0
36"		80.0	90.0	90.0
42"		76.2	90.0	90.0
48"		68.3	90.0	90.0
54"		62.5	90.0	90.0
60"		-	90.0	90.0
30"	96"	80.0	90.0	90.0
36"		75.7	90.0	90.0
42"		66.0	90.0	90.0
48"		59.0	90.0	90.0
54"		-	90.0	90.0
60"		-	90.0	90.0
30"	102"	-	90.0	90.0
36"		-	90.0	90.0
42"		-	90.0	90.0
48"		-	90.0	90.0
54"		-	-	80.0
60"		-	-	-
30"	108"	-	90.0	90.0
36"		-	90.0	90.0
42"		-	90.0	90.0
48"		-	87.5	87.5
54"		-	-	80.0
60"		-	-	-
30"	114"	-	-	80.0
36"		-	-	80.0
42"		-	-	80.0
48"		-	-	80.0
54"		-	-	80.0
60"		-	-	80.0
30"	120"	-	-	80.0
36"		-	-	80.0
42"		-	-	80.0
48"		-	-	80.0
54"		-	-	80.0
60"		-	-	80.0

NOTE:  
INTERPOLATION BETWEEN WIDTHS OR HEIGHTS ALLOWED.

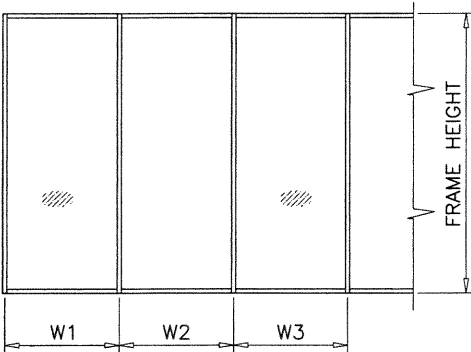

WIDTH (W) = W1  
AT FRAME JAMB

WIDTH (W) =  $\frac{W2 + W3}{2}$   
AT FRAME MULLION

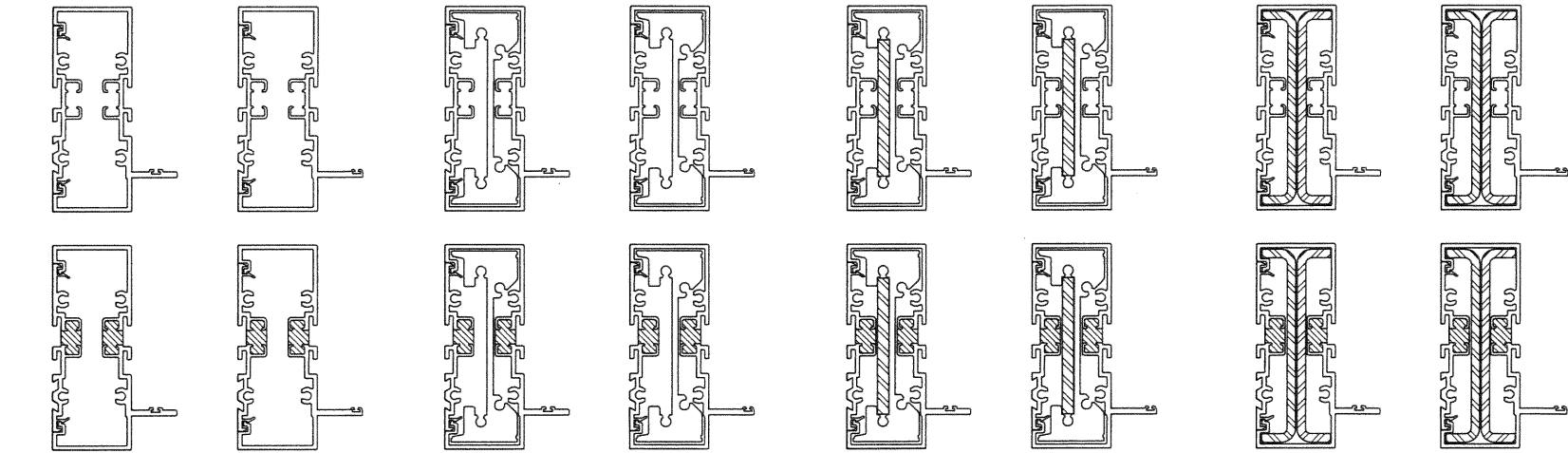

JAMB 'J1'		JAMB 'J2'		JAMB 'J3'		JAMB 'J4'	
Ix IN <sup>4</sup>	Sx IN <sup>3</sup>	Ix IN <sup>4</sup>	Sx IN <sup>3</sup>	Ix IN <sup>4</sup>	Sx IN <sup>3</sup>	Ix IN <sup>4</sup>	Sx IN <sup>3</sup>
3.634	1.720	9.241	4.375	ALUMINUM 9.241 4.375	STEEL .562 .375	ALUMINUM 3.634 1.720	STEEL 4.146 1.951
TOTAL Ix ALUM + Ix STL X 2.9 10.871		TOTAL Ix ALUM + Ix STL X 2.9 15.657		TOTAL Ix ALUM + Ix STL X 2.9 10.871		TOTAL Ix ALUM + Ix STL X 2.9 15.657	

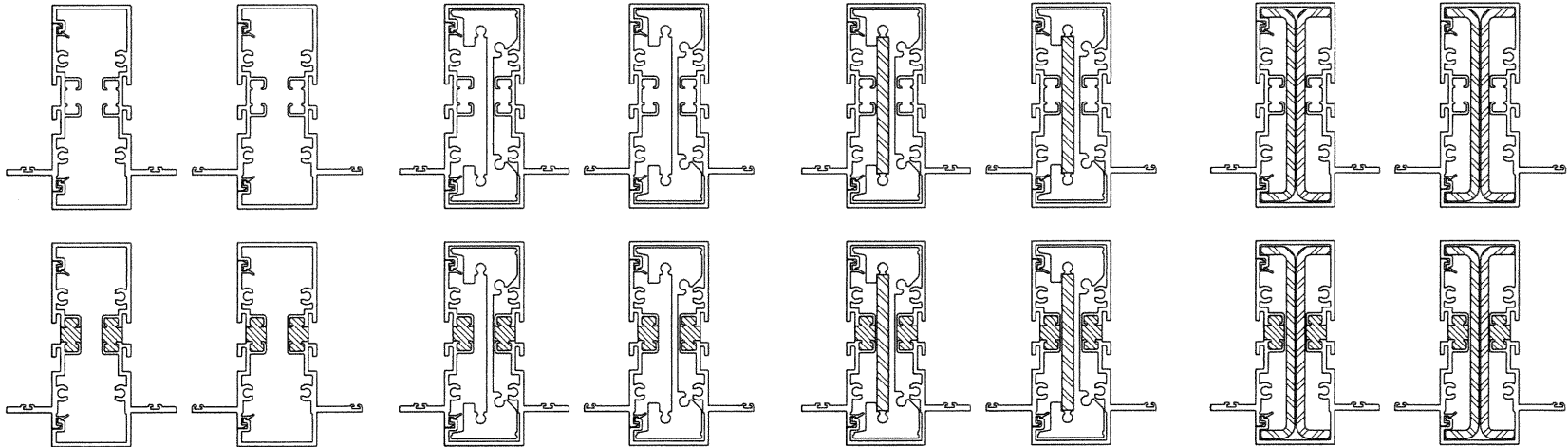

MULLION 'M1'		MULLION 'M2'		MULLION 'M3'		MULLION 'M4'	
Ix IN <sup>4</sup>	Sx IN <sup>3</sup>	Ix IN <sup>4</sup>	Sx IN <sup>3</sup>	Ix IN <sup>4</sup>	Sx IN <sup>3</sup>	Ix IN <sup>4</sup>	Sx IN <sup>3</sup>
3.854	1.614	9.461	3.963	ALUMINUM 9.461 3.963	STEEL .562 .375	ALUMINUM 3.854 1.614	STEEL 4.146 1.951
TOTAL Ix ALUM + Ix STL X 2.9 11.092		TOTAL Ix ALUM + Ix STL X 2.9 15.877		TOTAL Ix ALUM + Ix STL X 2.9 11.092		TOTAL Ix ALUM + Ix STL X 2.9 15.877	

**PRODUCT REVISED**  
as complying with the Florida  
Building Code  
NOA-No. **20-0910.07**  
Expiration Date: **05/12/2025**  
By: *Manuel Perez*  
Miami-Dade Product Control

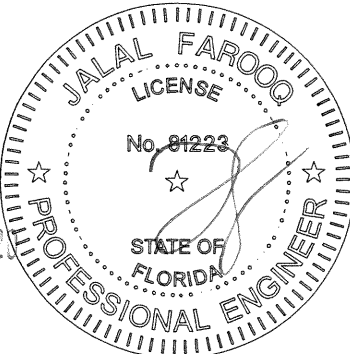

**af c**  
**AL-FAROOQ CORPORATION**  
ENGINEERS & PRODUCT DEVELOPMENT  
9360 SUNSET DRIVE, SUITE 220  
MIAMI, FLORIDA 33173  
TEL. (305) 264-8100 FAX. (305) 262-6978  
COMP-ANL\W09-24SM

SERIES SMI-090 ALUM WINDOW WALL (L.M.I.)  
**Aldora Aluminum & Glass Products Inc.**  
4250 Coral Ridge Drive, Suite 101  
Coral Springs, FL. 33065  
Tel. (954) 784-6900 Fax. (954) 784-6901

no	date	by	description
C	08.12.13	MANUF. NAME REV.	NO CHANGE THIS SHEET
D	03.05.14	GENERAL REVISION	REV. PER RER COMMENTS
E	01.11.17	REV. PER RER COMMENTS	UPDATED TO 2020 FBC
F	08.21.17	REV. PER RER COMMENTS	UPDATED TO 2020 FBC
G	06.25.20	REV. PER RER COMMENTS	UPDATED TO 2020 FBC

date:	04-16-09
scale:	-
dr. by:	TARIQ
chk. by:	

drawing no.	W09-24
sheet	3 of 13



DESIGN LOAD CAPACITY - PSF				
JAMB/MULLION WITH INTERMEDIATE HORIZONTALS				
NOMINAL DIMS.		JAMB 'J1'	JAMB 'J2'	JAMB 'J3/J4'
WIDTH (W)	FRAME HEIGHT	MULLION 'M1'	MULLION 'M2'	MULL 'M3/M4'
		EXT. (+) INT. (-)	EXT. (+) INT. (-)	EXT. (+) INT. (-)
30"	78"	80.0	90.0	90.0
36"		80.0	90.0	90.0
42"		80.0	90.0	90.0
48"		80.0	90.0	90.0
54"		74.2	90.0	90.0
60"		66.8	90.0	90.0
30"	84"	80.0	90.0	90.0
36"		80.0	90.0	90.0
42"		80.0	90.0	90.0
48"		71.6	90.0	90.0
54"		63.6	90.0	90.0
60"		-	90.0	90.0
30"	90"	80.0	90.0	90.0
36"		80.0	90.0	90.0
42"		70.8	90.0	90.0
48"		62.0	90.0	90.0
54"		55.1	90.0	90.0
60"		-	90.0	90.0
30"	96"	80.0	90.0	90.0
36"		72.2	90.0	90.0
42"		61.9	90.0	90.0
48"		54.2	90.0	90.0
54"		-	90.0	90.0
60"		-	-	80.0
30"	102"	-	90.0	90.0
36"		-	90.0	90.0
42"		-	90.0	90.0
48"		-	90.0	90.0
54"		-	-	80.0
60"		-	-	-
30"	108"	-	90.0	90.0
36"		-	90.0	90.0
42"		-	90.0	90.0
48"		-	87.5	87.5
54"		-	-	-
60"		-	-	-
30"	114"	-	-	80.0
36"		-	-	80.0
42"		-	-	80.0
48"		-	-	80.0
54"		-	-	-
60"		-	-	-
30"	120"	-	-	80.0
36"		-	-	80.0
42"		-	-	80.0
48"		-	-	80.0
54"		-	-	-
60"		-	-	-

NOTE:  
INTERPOLATION BETWEEN WIDTHS OR HEIGHTS ALLOWED.

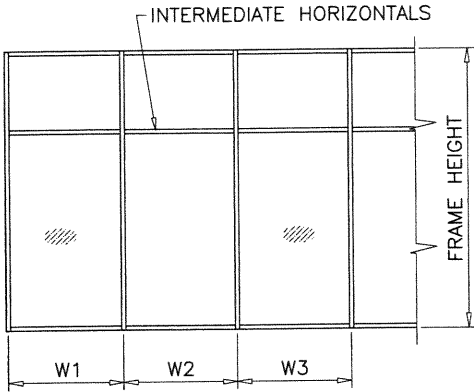

WIDTH (W) = W1  
AT FRAME JAMB

WIDTH (W) =  $\frac{W2 + W3}{2}$   
AT FRAME MULLION

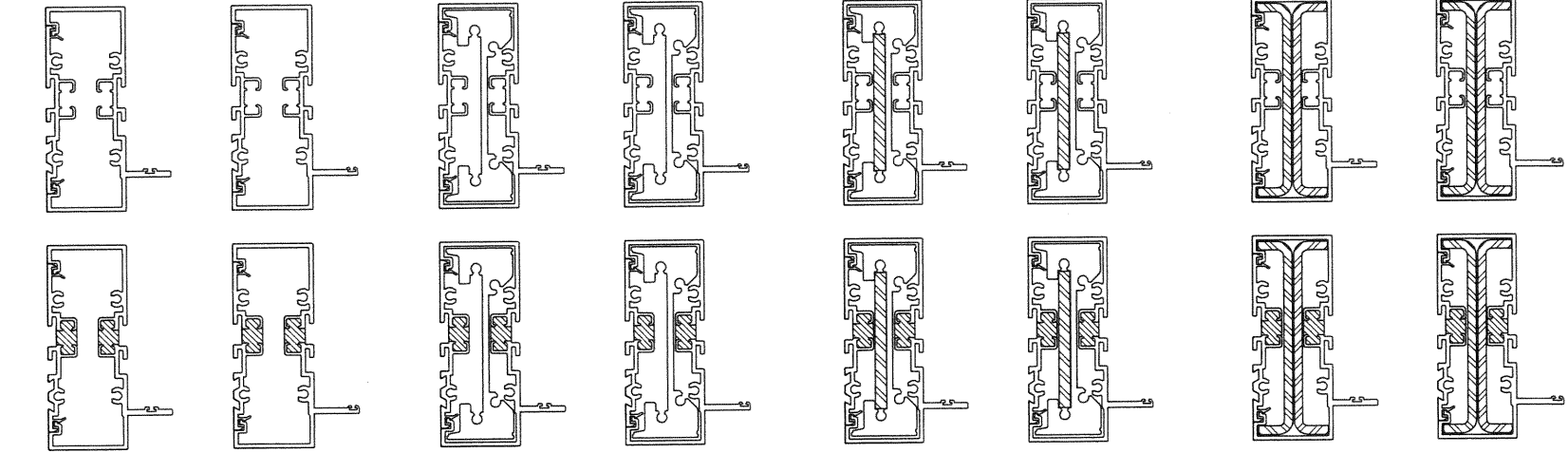

JAMB 'J1'

Ix IN <sup>4</sup>	Sx IN <sup>3</sup>
3.634	1.720

JAMB 'J2'

Ix IN <sup>4</sup>	Sx IN <sup>3</sup>
9.241	4.375

JAMB 'J3'

	Ix IN <sup>4</sup>	Sx IN <sup>3</sup>
ALUMINUM	9.241	4.375
STEEL	.562	.375
TOTAL	9.803	4.750
Ix ALUM + Ix STL X 2.9	10.871	

JAMB 'J4'

	Ix IN <sup>4</sup>	Sx IN <sup>3</sup>
ALUMINUM	3.634	1.720
STEEL	4.146	1.951
TOTAL	7.780	3.671
Ix ALUM + Ix STL X 2.9	15.657	

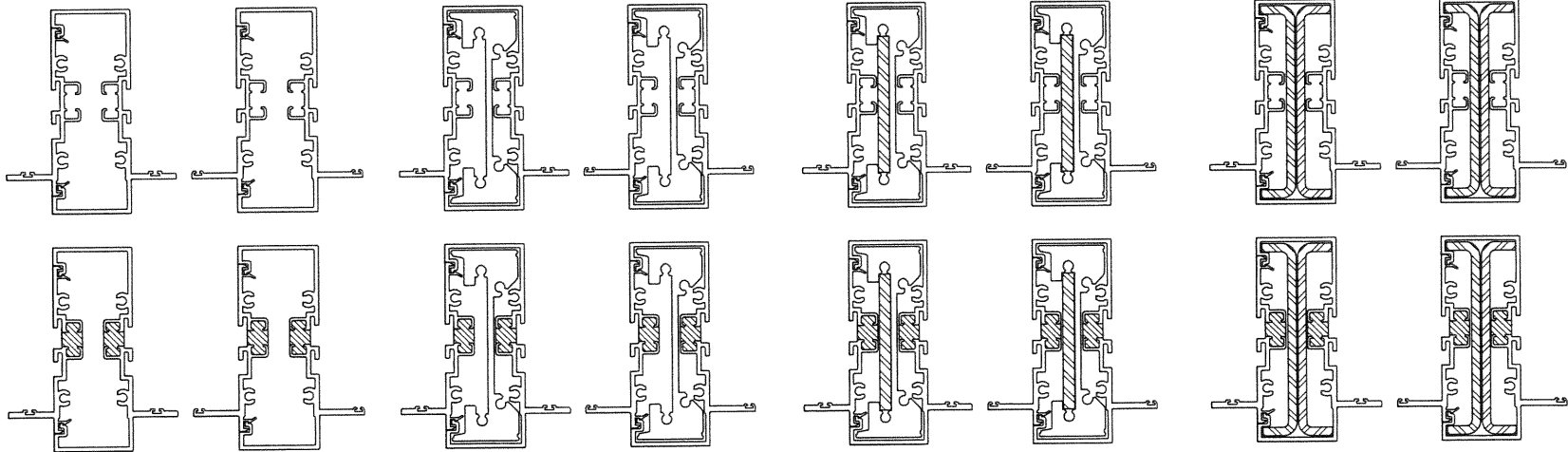

MULLION 'M1'

Ix IN <sup>4</sup>	Sx IN <sup>3</sup>
3.854	1.614

MULLION 'M2'

Ix IN <sup>4</sup>	Sx IN <sup>3</sup>
9.461	3.963

MULLION 'M3'

	Ix IN <sup>4</sup>	Sx IN <sup>3</sup>
ALUMINUM	9.461	3.963
STEEL	.562	.375
TOTAL	10.023	4.338
Ix ALUM + Ix STL X 2.9	11.092	

MULLION 'M4'

	Ix IN <sup>4</sup>	Sx IN <sup>3</sup>
ALUMINUM	3.854	1.614
STEEL	4.146	1.951
TOTAL	8.000	3.565
Ix ALUM + Ix STL X 2.9	15.877	

**PRODUCT REVISED**  
as complying with the Florida  
Building Code  
NOA-No. 20-0910.07  
Expiration Date: 05/12/2025  
By: *Manuel Peres*  
Miami-Dade Product Control

OCT 28 2020

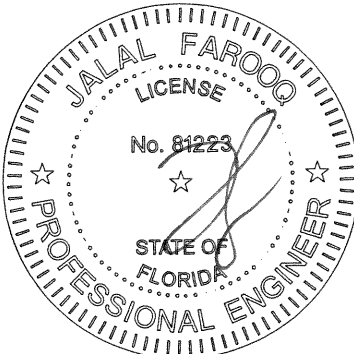

MULLIONS

**AL-FAROOQ CORPORATION**  
ENGINEERS & PRODUCT DEVELOPMENT  
9360 SUNSET DRIVE, SUITE 220  
MIAMI, FLORIDA 33173  
TEL. (305) 264-8100 FAX. (305) 262-6978  
COMP - ANL W09 - 24SM

SERIES SMI-090 ALUM WINDOW WALL (L.M.I.)

**Aldora Aluminum & Glass Products Inc.**  
4250 Coral Ridge Drive, Suite 101  
Coral Springs, FL 33065  
Tel. (954) 784-6900 Fax. (954) 784-6901

no.	date	by	description
C	08.12.13	MANUF. NAME	REV.
D	03.05.14		NO CHANGE THIS SHEET
E	01.11.17		GENERAL REVISION
F	08.21.17		REV. PER RER COMMENTS
G	06.25.20		UPDATED TO 2020 FBC

date: 04-16-09  
scale: -  
dr. by: TARIQ  
chk. by:

drawing no.  
**W09-24**  
sheet 4 of 13

ANCHOR LOAD CAPACITY - PSF EXT.(+) & INT.(-)						
NOMINAL DIMS.		ANCHORS TYPE 'A'		ANCHORS TYPE 'B'		ANCHORS 'C'
WIDTH (W)	FRAME HEIGHT	A2	A3	B2	B3	C2
30"	84"	90.0	90.0	90.0	90.0	90.0
36"		90.0	90.0	90.0	90.0	90.0
42"		90.0	90.0	90.0	90.0	90.0
48"		90.0	90.0	90.0	90.0	90.0
54"		90.0	90.0	90.0	90.0	90.0
60"		90.0	90.0	90.0	90.0	90.0
30"	90"	90.0	90.0	90.0	90.0	90.0
36"		90.0	90.0	90.0	90.0	90.0
42"		90.0	90.0	90.0	90.0	90.0
48"		90.0	90.0	90.0	90.0	90.0
54"		86.7	90.0	90.0	90.0	90.0
60"		81.9	90.0	89.3	90.0	90.0
30"	96"	90.0	90.0	90.0	90.0	90.0
36"		90.0	90.0	90.0	90.0	90.0
42"		90.0	90.0	90.0	90.0	90.0
48"		85.3	90.0	90.0	90.0	90.0
54"		79.1	90.0	86.3	90.0	90.0
60"		74.5	90.0	81.2	90.0	90.0
30"	102"	90.0	90.0	90.0	90.0	90.0
36"		90.0	90.0	90.0	90.0	90.0
42"		86.7	90.0	90.0	90.0	90.0
48"		78.8	90.0	85.8	90.0	90.0
54"		72.8	90.0	79.4	90.0	90.0
30"	108"	90.0	90.0	90.0	90.0	90.0
36"		90.0	90.0	90.0	90.0	90.0
42"		80.7	90.0	88.0	90.0	90.0
48"		73.1	90.0	79.7	90.0	90.0
30"	114"	90.0	90.0	90.0	90.0	90.0
36"		85.3	90.0	90.0	90.0	90.0
42"		75.5	90.0	82.3	90.0	90.0
48"		68.3	90.0	74.4	90.0	90.0
30"	120"	90.0	90.0	90.0	90.0	90.0
36"		80.3	90.0	87.5	90.0	90.0
42"		70.9	90.0	77.3	90.0	90.0
48"		64.0	90.0	69.8	90.0	90.0

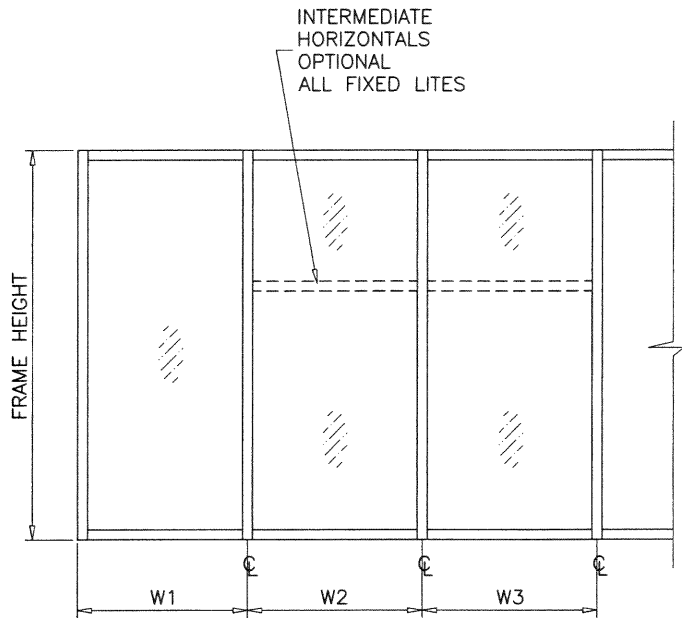

WIDTH (W) = W1  
AT FRAME JAMB

WIDTH (W) =  $\frac{W2 + W3}{2}$   
AT FRAME MULLION

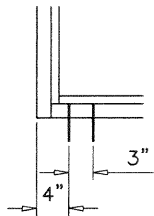

A2, B2, C2

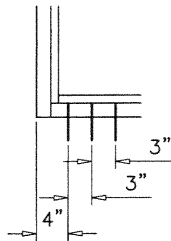

A3, B3

#### ANCHORS TYPES:

A2 = (2) ANCHORS TYPE 'A' AT EACH SIDE OF JAMB AND MULLION  
B2 = (2) ANCHORS TYPE 'B' AT EACH SIDE OF JAMB AND MULLION  
C2 = (2) ANCHORS TYPE 'C' AT EACH SIDE OF JAMB AND MULLION

A3 = (3) ANCHORS TYPE 'A' AT EACH SIDE OF JAMB AND MULLION  
B3 = (3) ANCHORS TYPE 'B' AT EACH SIDE OF JAMB AND MULLION  
C3 = (3) ANCHORS TYPE 'C' AT EACH SIDE OF JAMB AND MULLION

WOOD BUCKS AND METAL STRUCTURE NOT BY  
'ALDORA ALUMINUM & GLASS PRODUCTS'  
MUST SUSTAIN LOADS IMPOSED BY GLAZING SYSTEM AND  
TRANSFER THEM TO THE BUILDING STRUCTURE.

TYPICAL ANCHORS: SEE ELEV. FOR SPACING

#### TYPE 'A'

1/4" DIA. ULTRACON+ BY 'DEWALT' (Fu=164 KSI, Fy=148 KSI)  
INTO 2BY WOOD BUCKS OR WOOD STRUCTURES  
1-3/8" MIN. PENETRATION INTO WOOD (HEAD/SILL/JAMBS)  
THRU 1BY BUCKS INTO CONC. OR BLOCKS  
1-1/4" MIN. EMBED INTO CONCRETE (HEAD/SILL/JAMBS)  
1-1/4" MIN. EMBED INTO BLOCKS (JAMBS)

#### ANCHOR EDGE DISTANCES

INTO CONCRETE = 2-1/2" MIN.  
INTO WOOD STRUCTURE = 1" MIN.

#### TYPE 'B'

1/4" DIA. ULTRACON+ BY 'DEWALT' (Fu=164 KSI, Fy=148 KSI)  
DIRECTLY INTO CONCRETE OR BLOCKS  
1-1/4" MIN. EMBED INTO CONCRETE (HEAD/SILL/JAMBS)  
1-1/4" MIN. EMBED INTO BLOCKS (JAMBS)

#### ANCHOR EDGE DISTANCES

INTO CONCRETE = 2-1/2" MIN.

#### TYPE 'C'

#14 SMS OR SELF DRILLING SCREWS ST/ST (GRADE 2 CRS)  
INTO MIAMI-DADE COUNTY APPROVED MULLIONS  
OR  
INTO METAL STRUCTURES (HEAD/SILL/JAMBS)  
(3) THREADS MIN. PENETRATION BEYOND SUBSTRATE  
ALUMINUM: 1/8" THK. MIN. (6063-T5 MIN.)  
STEEL: 1/8" THK. MIN. (Fy = 36 KSI MIN.)  
(STEEL IN CONTACT WITH ALUMINUM TO BE PLATED OR PAINTED)

#### ANCHOR EDGE DISTANCES

INTO METAL STRUCTURE = 3/4" MIN.

WOOD AT HEAD, SILL OR JAMBS SG = 0.55 MIN.  
CONCRETE AT HEAD, SILL OR JAMBS f'c = 3000 PSI MIN.  
C-90 HOLLOW/FILLED BLOCK AT JAMBS f'm = 2000 PSI MIN.

PRODUCT REVISED  
as complying with the Florida  
Building Code  
NOA-No. 20-0910.07  
Expiration Date: 05/12/2025

By: *Manuel Perera*  
Miami-Dade Product Control

OCT 23 2020

ANCHORS

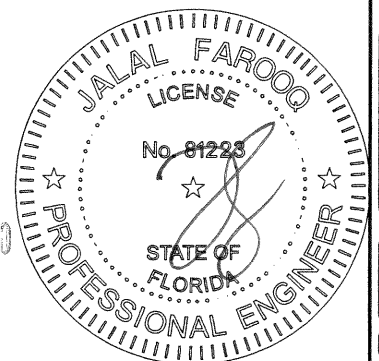

SERIES SMI-090 ALUM WINDOW WALL (L.M.I.)

Aldora Aluminum & Glass Products Inc.  
4250 Coral Ridge Drive, Suite 101  
Coral Springs, FL 33065  
Tel. (954) 784-6900 Fax. (954) 784-6901

no.	date	by	description
C	06.12.13	MANUF.	NAME REV.
D	03.05.14	NO	CHANGE THIS SHEET
E	01.11.17	GENERAL	REVISION
F	08.21.17	REV. PER	REVISIONS
G	06.25.20	UPDATED	TO 2020 FBC

date:	04-16-09
scale:	1/2" = 1"
dr. by:	TARIQ
chk. by:	

drawing no.  
W09-24

sheet 5 of 13

afc

AL-FAROOQ CORPORATION  
ENGINEERS & PRODUCT DEVELOPMENT  
9360 SUNSET DRIVE, SUITE 220  
MIAMI, FLORIDA 33173 (C.A.N. 3538)  
TEL. (305) 264-8100 FAX. (305) 262-6978

COMP-ANL\W09-24SM



DOOR MULLION LOAD CAPACITY		
NOMINAL DIMS.		W/O REINF.
WIDTH (W)	FRAME HEIGHT	EXT.(+) & INT.(-)
30"	81-3/4"	90.0
36"		90.0
42"		90.0
48"		90.0
30"	85-3/4"	90.0
36"		90.0
42"		90.0
48"		90.0
30"	91-3/4"	90.0
36"		90.0
42"		90.0
48"		90.0
30"	96-3/4"	90.0
36"		90.0
42"		90.0
48"		90.0
30"	97-3/4"	90.0
36"		90.0
42"		90.0
48"		90.0

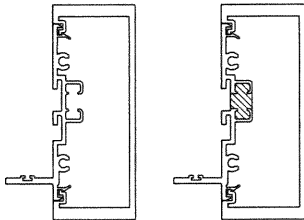

DOOR MULLION  
WITHOUT REINFORCING

Ix IN^4	Sx IN^3
5.856	2.602

DOOR MULLION LOAD CAPACITY		
NOMINAL DIMS.		WITH REINF.
WIDTH (W)	FRAME HEIGHT	EXT.(+) & INT.(-)
24"	80"	90.0
30"		90.0
36"		90.0
42"		90.0
48"		90.0
24"	84"	90.0
30"		90.0
36"		90.0
42"		90.0
48"		90.0
24"	90"	90.0
30"		90.0
36"		90.0
42"		90.0
48"		90.0
24"	96"	90.0
30"		90.0
36"		90.0
42"		90.0
48"		90.0
24"	102"	90.0
30"		90.0
36"		90.0
42"		90.0
48"		90.0
24"	108"	90.0
30"		90.0
36"		90.0
42"		90.0
48"		90.0
24"	114"	80.0
30"		80.0
36"		80.0
42"		80.0
48"		80.0
24"	120"	80.0
30"		80.0
36"		80.0
42"		80.0
48"		80.0

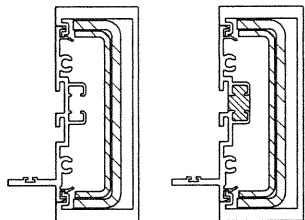

DOOR MULLION  
WITH REINFORCING

	Ix IN^4	Sx IN^3
ALUMINUM	5.856	2.602
STEEL	2.740	1.391
TOTAL	13.802	
Ix ALUM + Ix STL X 2.9		

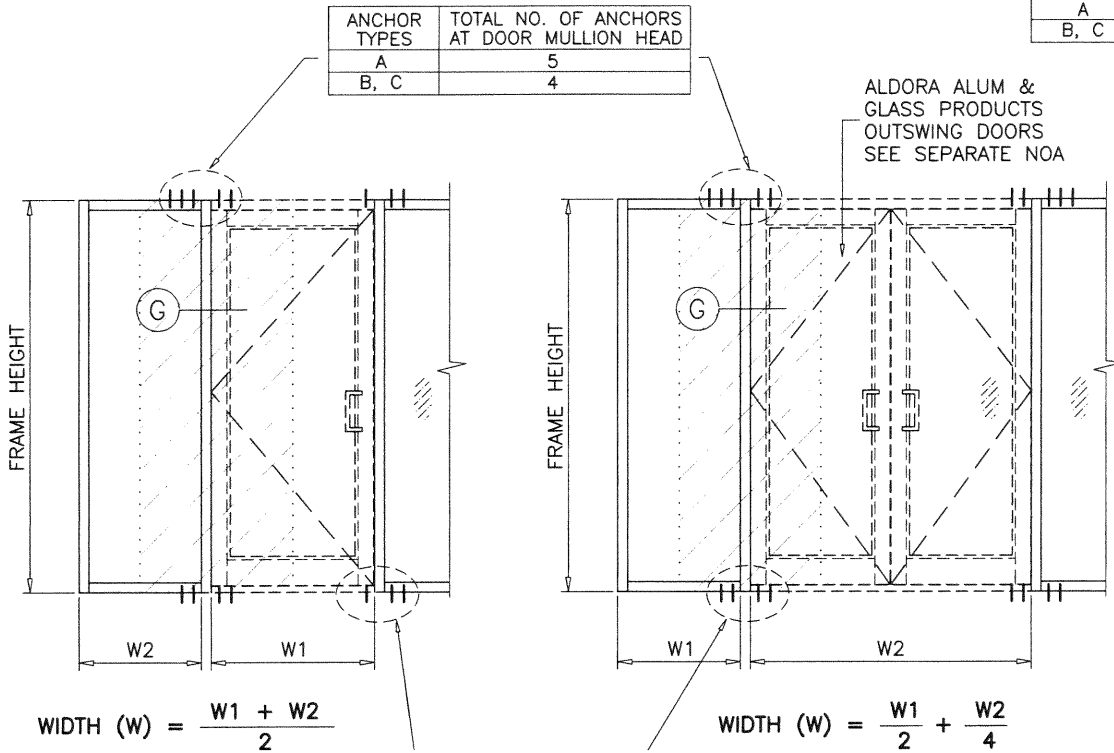

ANCHOR TYPES	TOTAL NO. OF ANCHORS AT DOOR MULLION HEAD
A	5
B, C	4

ALDORA ALUM & GLASS PRODUCTS  
OUTSWING DOORS  
SEE SEPARATE NOA

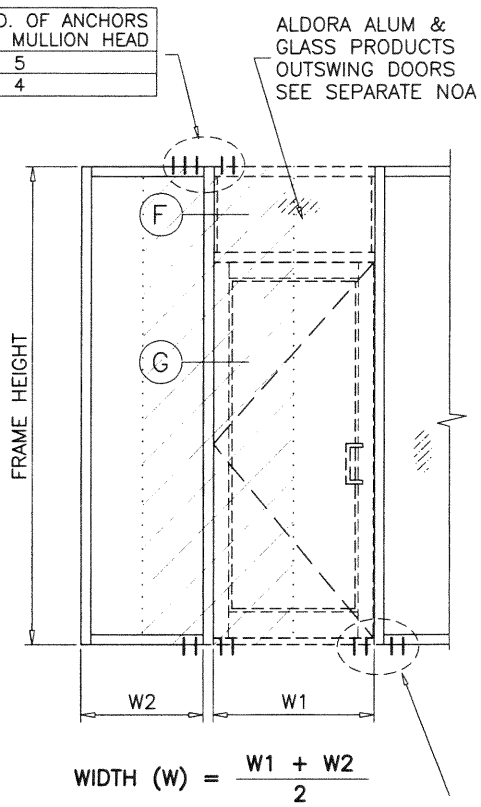

ANCHOR TYPES	TOTAL NO. OF ANCHORS AT DOOR MULLION SILL
B	4

ALDORA ALUM & GLASS PRODUCTS  
OUTSWING DOORS  
SEE SEPARATE NOA

**PRODUCT REVISED**  
as complying with the Florida  
Building Code  
NOA-No. **20-0910.07**  
Expiration Date: **05/12/2025**  
By: *Manuel Torres*  
Miami-Dade Product Control

OCT 2 8 2020

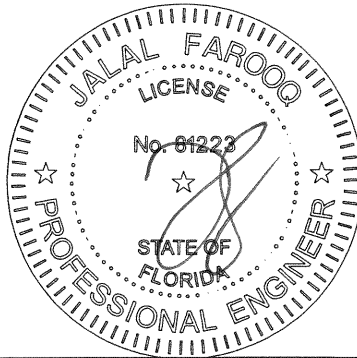

DOOR MULLION

**AL-FAROOQ CORPORATION**  
ENGINEERS & PRODUCT DEVELOPMENT  
9360 SUNSET DRIVE, SUITE 220  
MIAMI, FLORIDA 33173  
TEL. (305) 264-8100 FAX. (305) 262-6978  
(C.A.N. 3538)

SERIES SMI-090 ALUM WINDOW WALL (L.M.I.)  
**Aldora Aluminum & Glass Products Inc.**  
4250 Coral Ridge Drive, Suite 101  
Coral Springs, FL. 33065  
Tel. (954) 784-6900 Fax. (954) 784-6901

no	date	by	description
C	08.12.13		MANUF. NAME REV.
D	03.05.14		NO CHANGE THIS SHEET
E	01.11.17		GENERAL REVISION
F	08.21.17		NO CHANGE THIS SHEET
G	06.25.20		UPDATED TO 2020 FBC

date: 04-16-09	scale: 1/2" = 1"
dr. by: TARIQ	chk. by:

drawing no.  
**W09-24**  
sheet 6 of 13

DOOR MULLION LOAD CAPACITY - PSF				
NOMINAL DIMS.				WITH REINF.
FRAME HEIGHT INCHES	DOOR HEIGHT INCHES	WIDTH (W1) INCHES	WIDTH (W2) INCHES	EXT. (+) INT. (-)
108	80	60	30	90.0
			33	90.0
			39	90.0
			42	90.0
		72	30	90.0
			33	90.0
			39	90.0
			42	90.0
		84	30	90.0
			33	90.0
			39	90.0
			42	89.1
		96	30	90.0
			33	87.9
			39	83.6
			42	81.6
114	80	60	30	80.0
			33	80.0
			39	80.0
			42	80.0
		72	30	80.0
			33	80.0
			39	80.0
			42	80.0
		84	30	80.0
			33	80.0
			39	80.0
			42	78.0
		96	30	78.6
			33	76.7
			39	73.1
120	80	60	30	80.0
			33	80.0
			39	80.0
			42	80.0
		72	30	80.0
			33	80.0
			39	78.4
			42	76.3
		84	30	76.7
			33	74.7
			39	70.9
			42	69.1
		96	30	69.5
			33	67.8

DOOR MULLION LOAD CAPACITY - PSF				
NOMINAL DIMS.				WITH REINF.
FRAME HEIGHT INCHES	DOOR HEIGHT INCHES	WIDTH (W1) INCHES	WIDTH (W2) INCHES	EXT. (+) INT. (-)
108	84	60	30	90.0
			33	90.0
			39	90.0
			42	90.0
		72	30	90.0
			33	90.0
			39	90.0
			42	90.0
		84	30	90.0
			33	90.0
			39	90.0
			42	90.0
		96	30	90.0
			33	90.0
			39	86.2
			42	84.1
114	84	60	30	80.0
			33	80.0
			39	80.0
			42	80.0
		72	30	80.0
			33	80.0
			39	80.0
			42	80.0
		84	30	80.0
			33	80.0
			39	80.0
			42	79.7
		96	30	80.0
			33	78.6
			39	74.8
120	84	60	30	80.0
			33	80.0
			39	80.0
			42	80.0
		72	30	80.0
			33	80.0
			39	79.7
			42	77.5
		84	30	78.2
			33	76.1
			39	72.1
			42	70.3
		96	30	70.9
			33	69.1

DOOR MULLION LOAD CAPACITY - PSF				
NOMINAL DIMS.				WITH REINF.
FRAME HEIGHT INCHES	DOOR HEIGHT INCHES	WIDTH (W1) INCHES	WIDTH (W2) INCHES	EXT. (+) INT. (-)
114	96	60	30	80.0
			33	80.0
			39	80.0
			42	80.0
		72	30	80.0
			33	80.0
			39	80.0
			42	80.0
		84	30	80.0
			33	80.0
			39	80.0
			42	80.0
		96	30	80.0
			33	80.0
			39	80.0
120	96	60	30	80.0
			33	80.0
			39	80.0
			42	80.0
		72	30	80.0
			33	80.0
			39	80.0
			42	80.0
		84	30	80.0
			33	80.0
			39	77.8
			42	75.7
		96	30	77.2
			33	75.1

DOOR MULLION LOAD CAPACITY - PSF				
NOMINAL DIMS.				WITH REINF.
FRAME HEIGHT INCHES	DOOR HEIGHT INCHES	WIDTH (W1) INCHES	WIDTH (W2) INCHES	EXT. (+) INT. (-)
120	108	60	30	80.0
			33	80.0
			39	80.0
			42	80.0
		72	30	80.0
			33	80.0
			39	80.0
			42	80.0
		84	30	80.0
			33	80.0
			39	80.0
			42	80.0
		96	30	80.0
			33	80.0

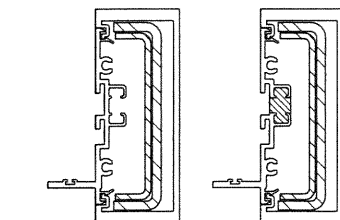

DOOR MULLION  
WITH REINFORCING

	Ix IN <sup>4</sup>	Sx IN <sup>3</sup>
ALUMINUM	5.856	2.602
STEEL	2.740	1.391
TOTAL Ix ALUM + Ix STL X 2.9	13.802	

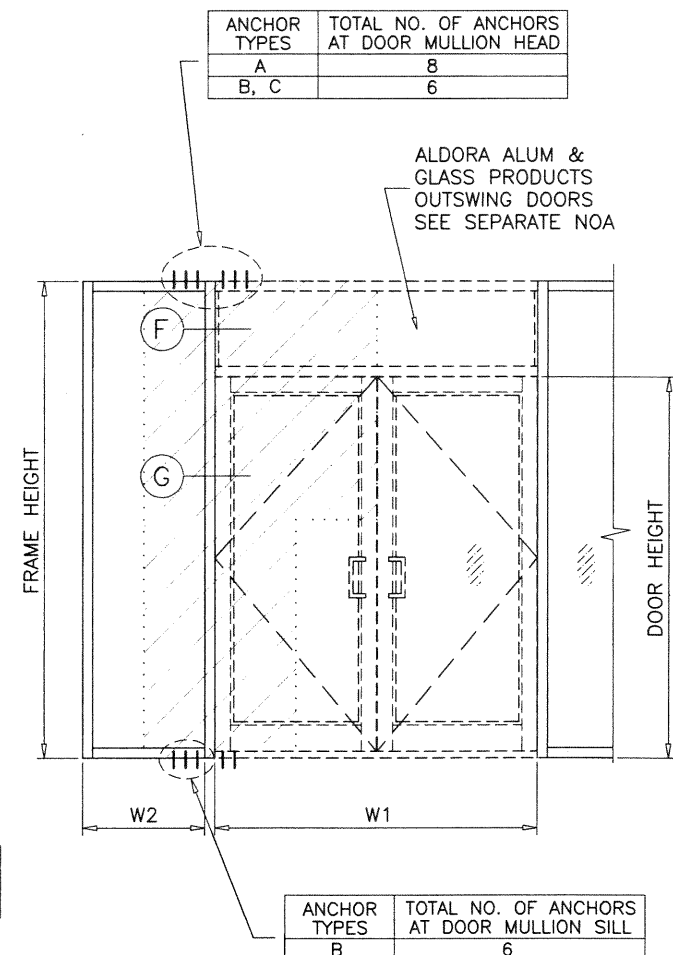

ANCHOR TYPES	TOTAL NO. OF ANCHORS AT DOOR MULLION SILL
B	6

**PRODUCT REVISED**  
as complying with the Florida  
Building Code  
NOA-No. **20-0910.07**  
Expiration Date: **05/12/2025**  
By: *Manuel Fern*  
Miami-Dade Product Control

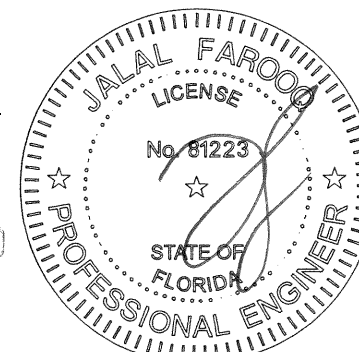

**AL-FAROOQ CORPORATION**  
ENGINEERS & PRODUCT DEVELOPMENT  
9360 SUNSET DRIVE SUITE 220  
MIAMI, FLORIDA 33173  
TEL. (305) 264-8100 FAX. (305) 262-6978  
(C.A.N. 3538)

SERIES SMI-090 ALUM WINDOW WALL (L.M.I.)  
**Aldora Aluminum & Glass Products Inc.**  
4250 Coral Ridge Drive, Suite 101  
Coral Springs, FL 33065  
Tel. (954) 784-6900 Fax. (954) 784-6901

revisions:	no	date	by	description
	C	06.12.13	MANUF.	NAME REV.
	D	03.05.14		NO CHANGE THIS SHEET
	E	01.11.17		GENERAL REVISION
	F	08.21.17		REV. PER RER COMMENTS
	G	06.25.20		UPDATED TO 2020 FBC

date: 04-16-09  
scale: 1/2" = 1"  
dr. by: TARIQ  
chk. by:

drawing no.  
**W09-24**  
sheet 7 of 13

DOOR MULLION

OCT 23 2020



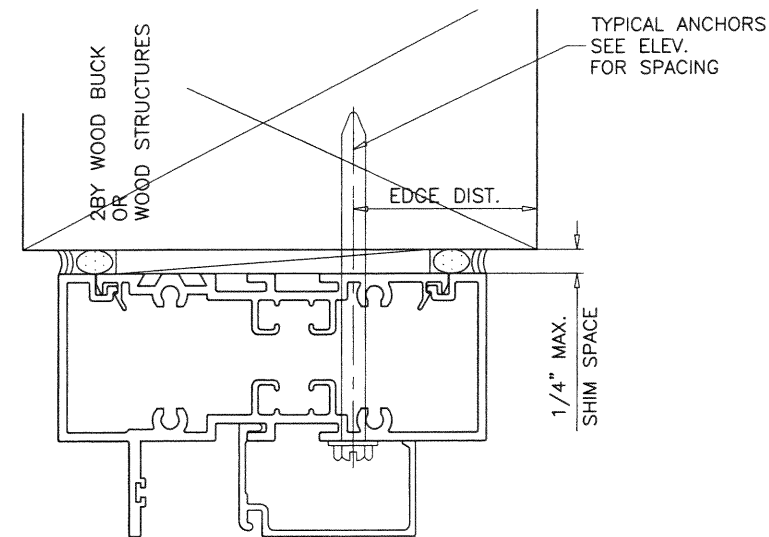
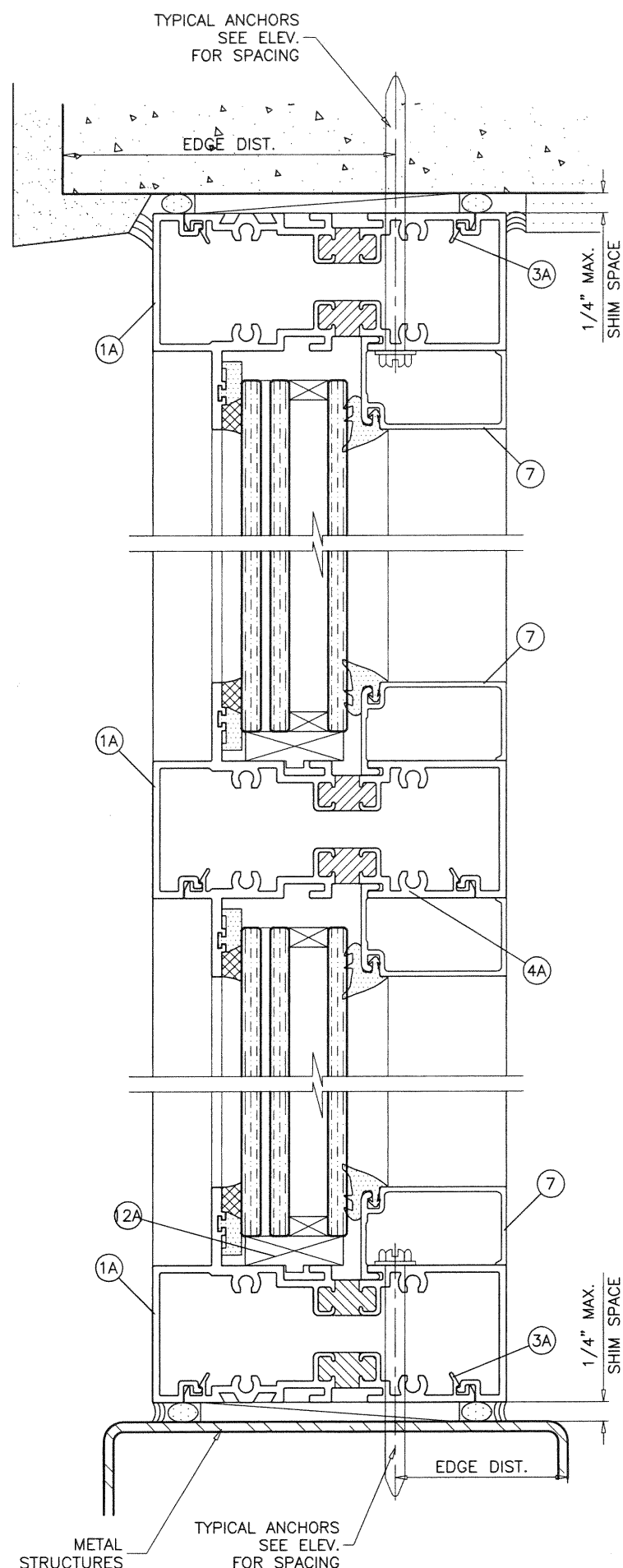
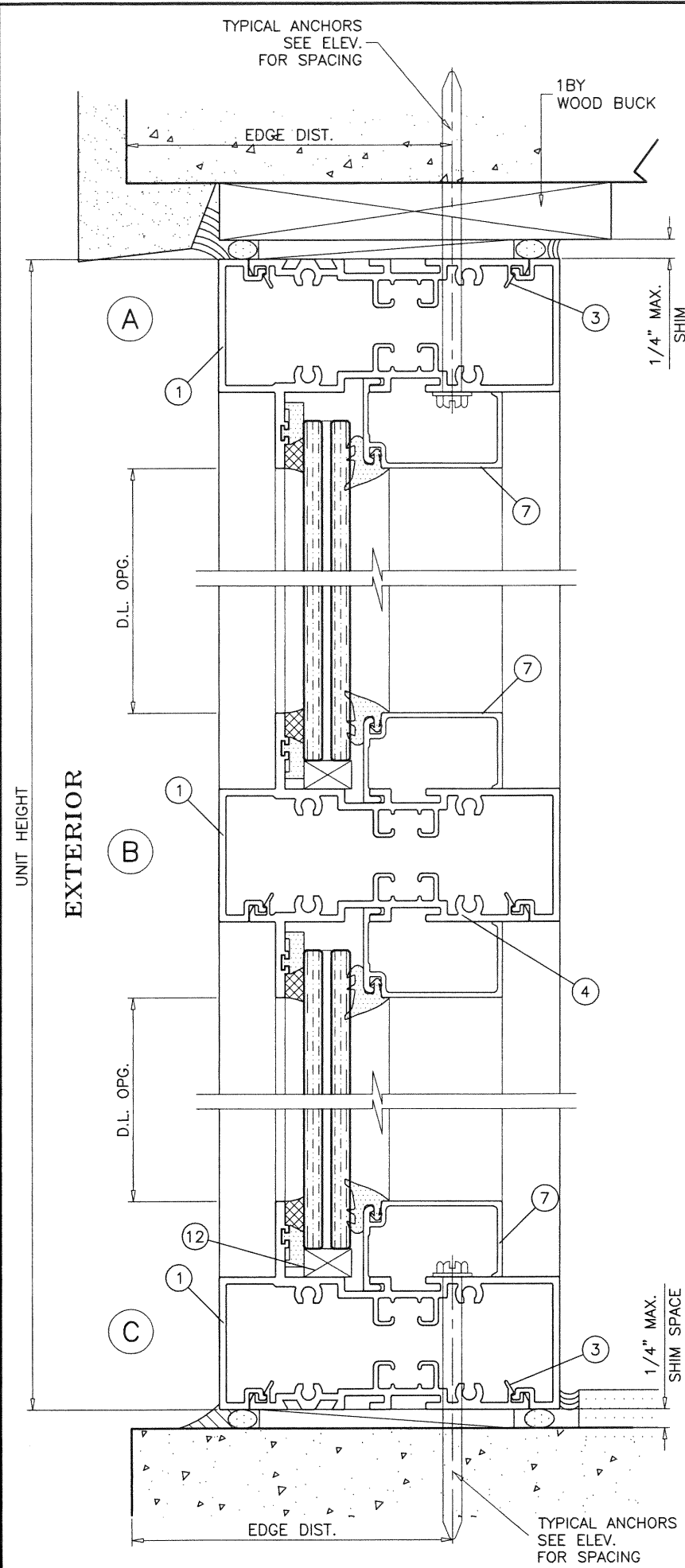

**INTERIOR GLAZED**

**PRODUCT REVISED**  
as complying with the Florida  
Building Code  
NOA-No. **20-0910.07**  
Expiration Date: **05/12/2025**  
By: *Manuel Perez*  
Miami-Dade Product Control

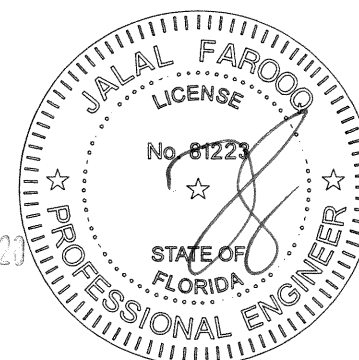

**AL-FAROOQ CORPORATION**  
ENGINEERS & PRODUCT DEVELOPMENT  
9360 SUNSET DRIVE, SUITE 220  
MIAMI, FLORIDA 33173 (C.A.N. 3538)  
TEL. (305) 264-8100 FAX. (305) 262-6978

COMP-ANL\W09-24SM

---

SERIES SMI-090 ALUM WINDOW WALL (L.M.I.)

**Aldora Aluminum & Glass Products Inc.**  
4250 Coral Ridge Drive, Suite 101  
Coral Springs, FL. 33065  
Tel. (954) 784-6900 Fax. (954) 784-6901

no	date	by	description
C	08.12.13		MANUF. NAME REV.
D	03.05.14		NO CHANGE THIS SHEET
E	01.11.17		GENERAL REVISION
F	08.21.17		NO CHANGE THIS SHEET
G	06.25.20		UPDATED TO 2020 FBC

---

date: 04-16-09  
scale: 1/2" = 1"  
dr. by: TARIQ  
chk. by:

drawing no.  
**W09-24**  
sheet 8 of 13

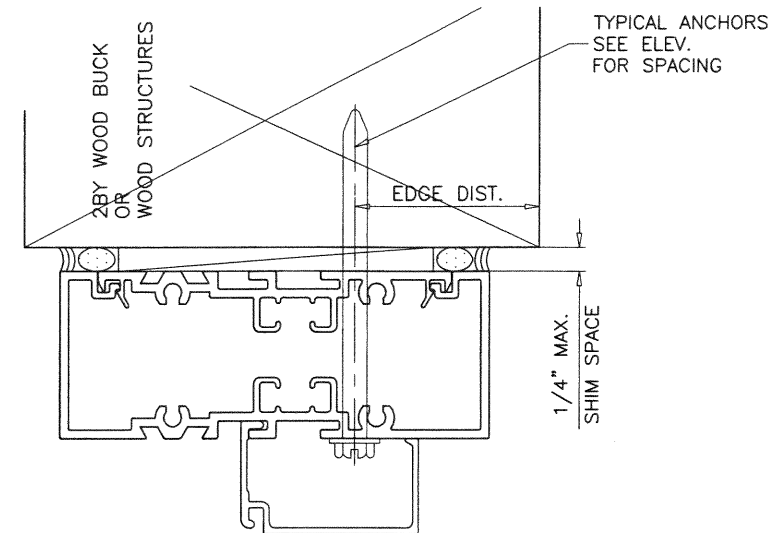
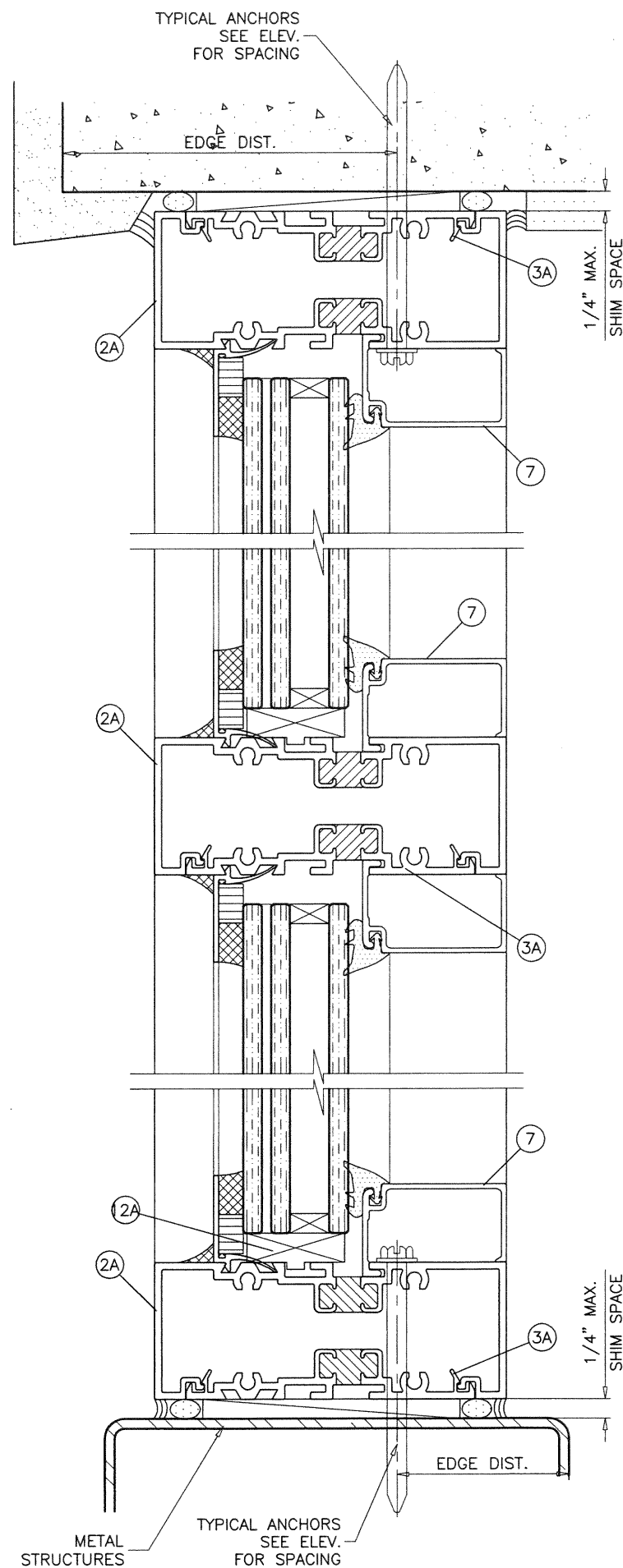

OCT 23 2020

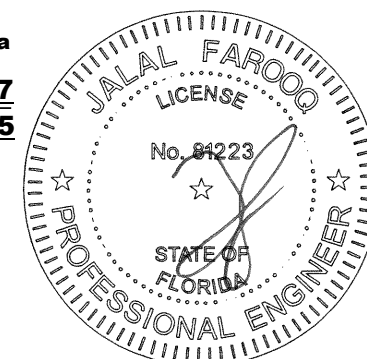

sheet 9 of 13

1000

TEL. (305) 264-8100 FAX. (305) 262-6978

© 2006 The Authors  
Journal compilation © 2006 Blackwell Publishing Ltd

COMP--ANL \W09-Z4SM



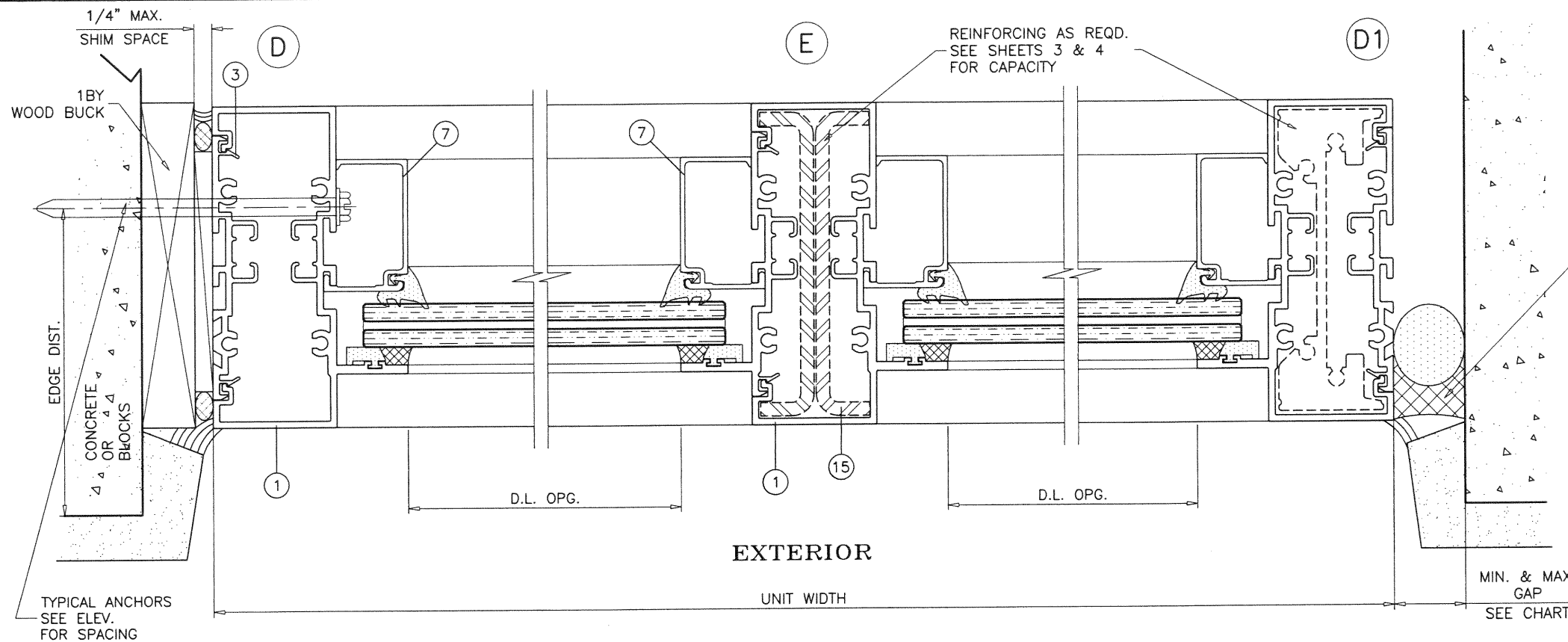

SILICONE  
DOW CORNING CCS  
DEPTH = 3/8\"

MAX. FRAME HEIGHT	GAP	
	MIN.	MAX.
72"	3/8"	1/2"
96"	1/2"	3/4"
120"	5/8"	1"

MIN. & MAX.  
GAP  
SEE CHART

WOOD BUCK FILLER  
OPTIONAL  
BY OTHERS

REINFORCING AS REQD.  
SEE SHEETS 3 & 4  
FOR CAPACITY

REINFORCING AS REQD.  
SEE SHEETS 3 & 4  
FOR CAPACITY

TYPICAL ANCHORS  
SEE ELEV.  
FOR SPACING

TYPICAL ANCHORS  
SEE ELEV.  
FOR SPACING

1/4\"

2BY WOOD BUCK  
OR  
WOOD STRUCTURES

NOTE:  
REINFORCINGS NOT REQUIRED AT SECURED JAMBS

**PRODUCT REVISED**  
as complying with the Florida  
Building Code

NOA-No. **20-0910.07**

Expiration Date: **05/12/2025**

By: *Manuel Perez*

Miami-Dade Product Control

OCT 28 2020

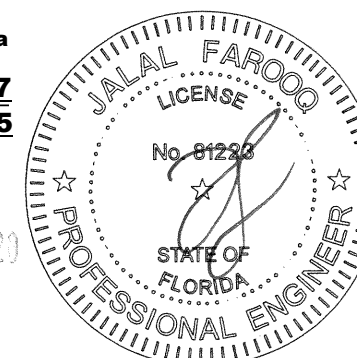

INTERIOR OR EXTERIOR GLAZED

**afC**  
**AL-FAROOQ CORPORATION**  
ENGINEERS & PRODUCT DEVELOPMENT  
9360 SUNSET DRIVE, SUITE 220  
MIAMI, FLORIDA 33173 (C.A.N. 3538)  
TEL. (305) 264-8100 FAX. (305) 262-6978

SERIES SMI-090 ALUM WINDOW WALL (L.M.I.)

**Aldora Aluminum & Glass Products Inc.**  
4250 Coral Ridge Drive, Suite 101  
Coral Springs, FL. 33065  
Tel. (954) 784-6900 Fax. (954) 784-6901

no	date	description	by
C	08.12.13	MANUF. NAME REV.	
D	03.05.14	NO CHANGE THIS SHEET	
E	01.11.17	GENERAL REVISION	
F	08.21.17	REV. PER RER COMMENTS	
G	06.25.20	UPDATED TO 2020 FBC	

date:	04-16-09
scale:	1/2" = 1"
dr. by:	TARIQ
chk. by:	

drawing no.

**W09-24**

sheet 10 of 13

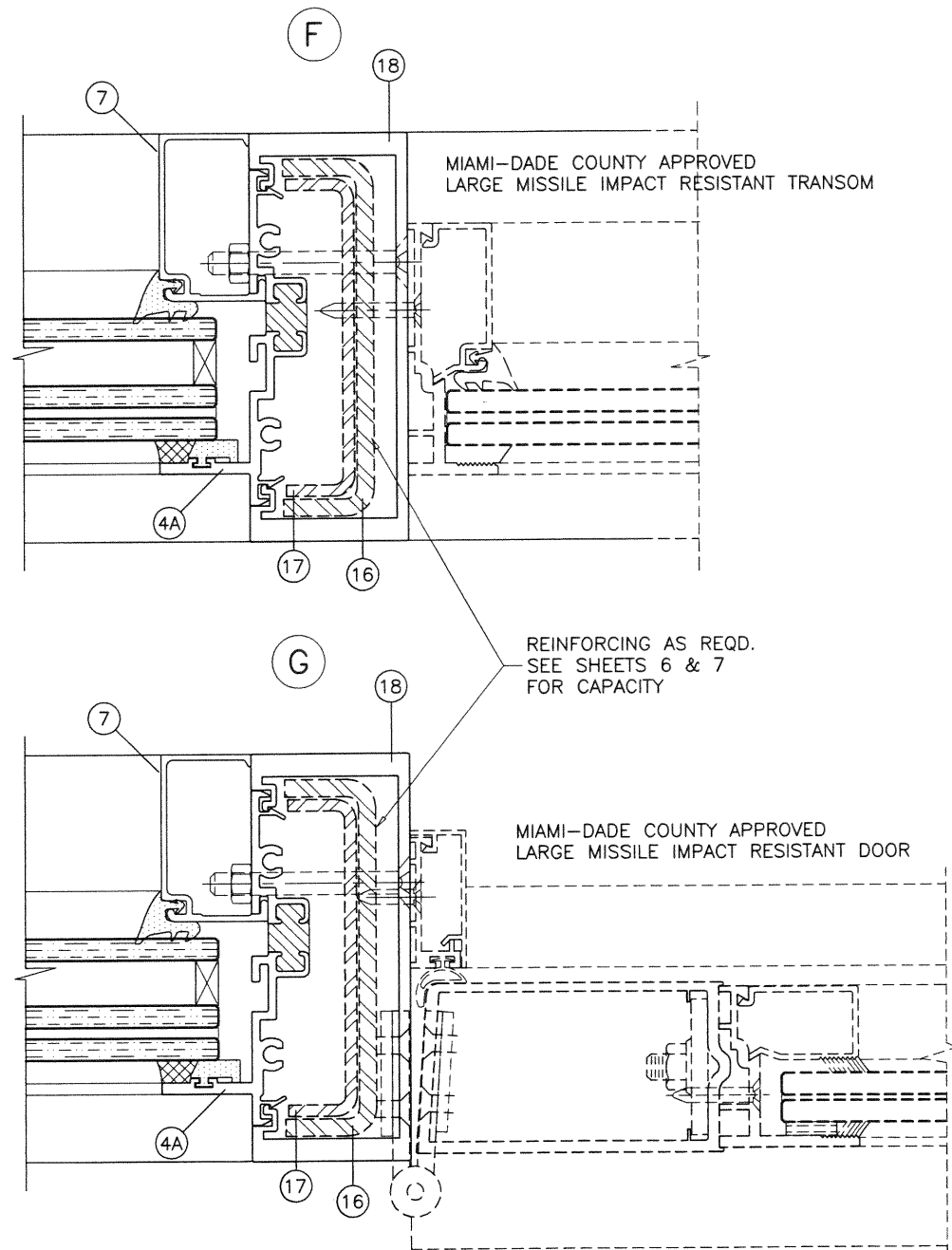
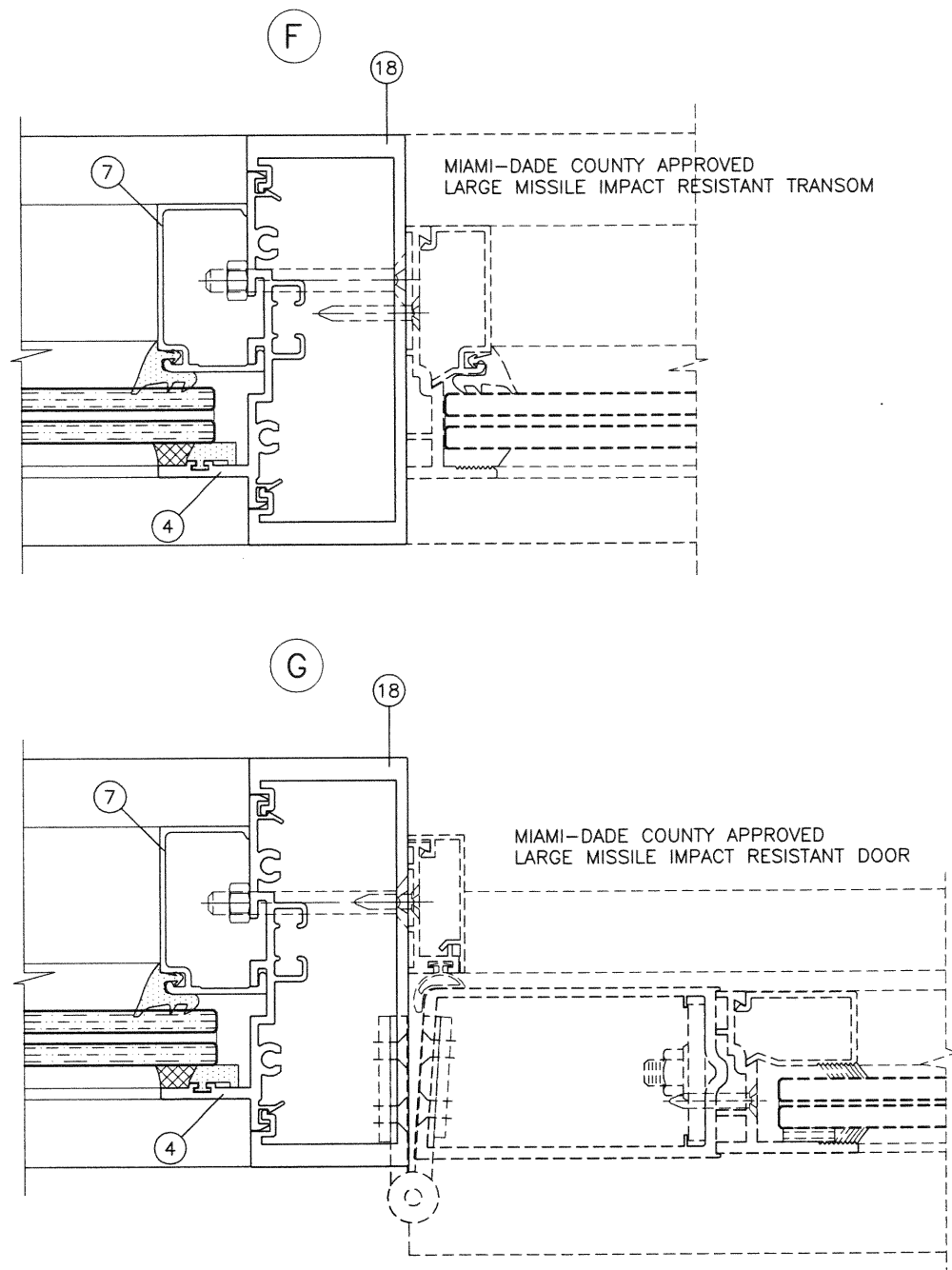

**PRODUCT REVISED**  
as complying with the Florida  
Building Code  
NOA-No. **20-0910.07**  
Expiration Date: **05/12/2025**  
By: *Manuel Perez*  
Miami-Dade Product Control

OCT 28 2020

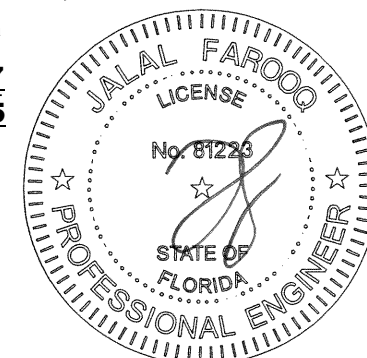

SEE SEPARATE NOA FOR DESIGN LOAD  
CAPACITY OF DOORS AND DOOR ANCHORS.  
LOWER VALUES FROM DOORS NOA  
OR STOREFRONT SYSTEM CAPACITY CHARTS  
WILL APPLY TO ENTIRE SYSTEM.

**af c**  
**AL-FAROOQ CORPORATION**  
ENGINEERS & PRODUCT DEVELOPMENT  
9360 SUNSET DRIVE, SUITE 220  
MIAMI, FLORIDA 33173 (C.A.N. 3538)  
TEL. (305) 264-8100 FAX. (305) 262-6978  
COMP - ANL \ W09 - 24SM

SERIES SMI-090 ALUM WINDOW WALL (L.M.I.)  
**Aldora Aluminum & Glass Products Inc.**  
4250 Coral Ridge Drive, Suite 101  
Coral Springs, FL 33065  
Tel. (954) 784-6900 Fax. (954) 784-6901

revisions:

no	date	by	description
C	08.12.13	MANUF. NAME	REV.
D	03.05.14	NO CHANGE	THIS SHEET
E	01.11.17	GENERAL	REVISION
F	08.21.17	REV. PER	REVISION COMMENTS
G	06.25.20	UPDATED	TO 2020 FBC

date: 04-16-09  
scale: 1/2" = 1"  
dr. by: TARIQ  
chk. by:

drawing no.  
**W09-24**  
sheet 11 of 13



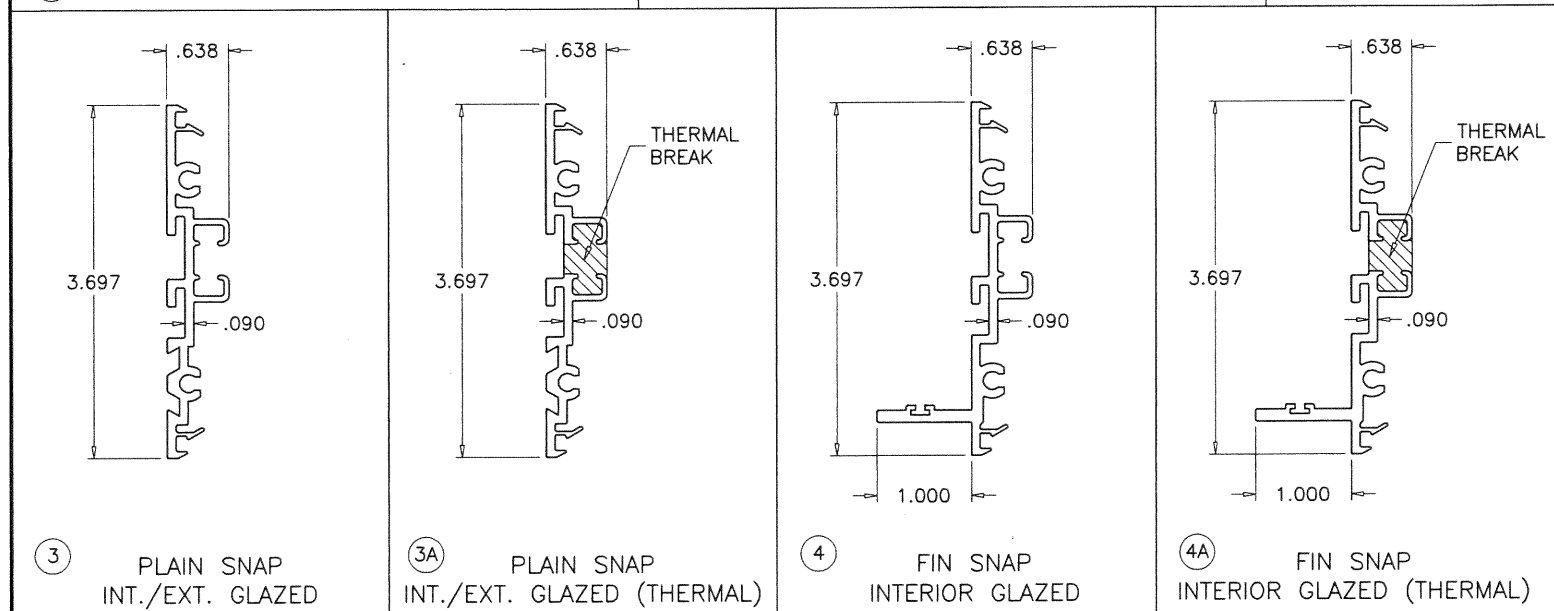
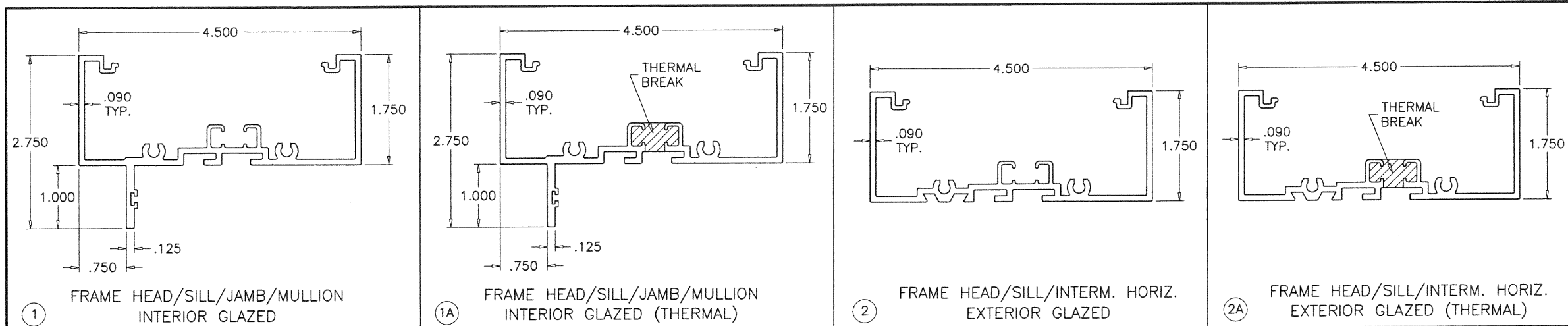

THERMAL BREAK:  
FRAME MEMBERS FILLED AND DEBRIDGED USING  
'AZON SU312-19T' STRUCTURAL THERMAL BARRIER POLYMER  
MANUFACTURED BY 'AZON USA INC.'.

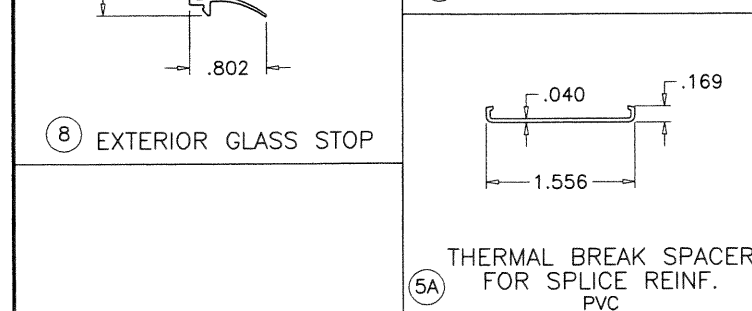
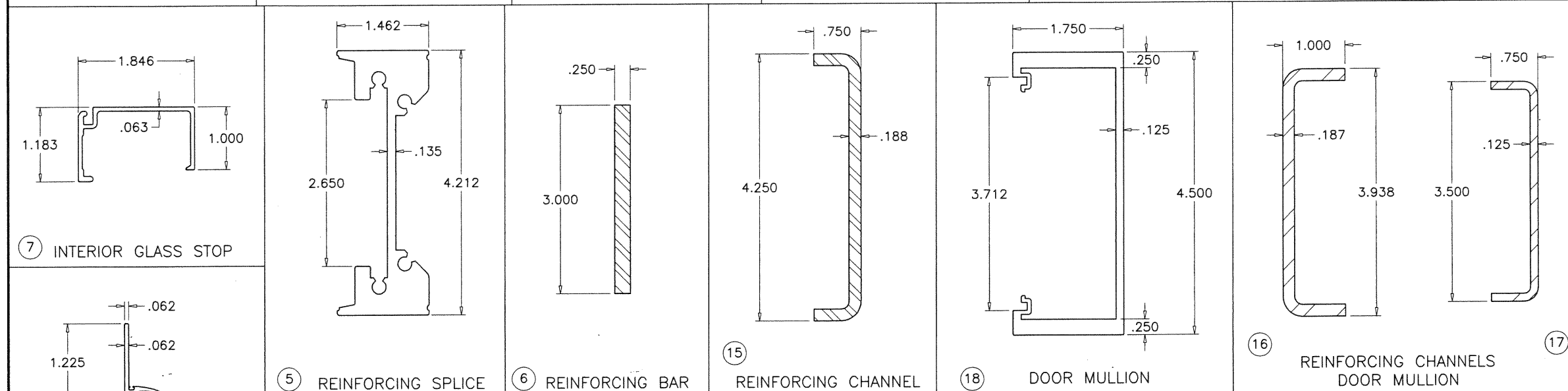

**PRODUCT REVISED**  
as complying with the Florida  
Building Code  
NOA-No. **20-0910.07**  
Expiration Date: **05/12/2025**  
By: *Manuel Perez*  
Miami-Dade Product Control

OCT 28 2020

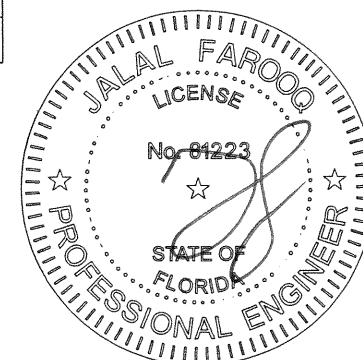

**AL-FAROOQ CORPORATION**  
ENGINEERS & PRODUCT DEVELOPMENT  
9360 SUNSET DRIVE, SUITE 220  
MIAMI, FLORIDA 33173 (C.A.N. 3538)  
TEL. (305) 264-8100 FAX. (305) 262-6978  
COMP-ANL W09-24SM

SERIES SMI-090 ALUM WINDOW WALL (L.M.I.)  
**Aldora Aluminum & Glass Products Inc.**  
4250 Coral Ridge Drive, Suite 101  
Coral Springs, FL. 33065  
Tel. (954) 784-6900 Fax. (954) 784-6901

revisions:		description
no	date	by
C	08.12.13	MANUF. NAME REV.
D	03.05.14	NO CHANGE THIS SHEET
E	01.11.17	GENERAL REVISION
F	08.21.17	REV. PER RER COMMENTS
G	06.25.20	UPDATED TO 2020 FBC

date:	04-16-09
scale:	1/2" = 1"
dr. by:	TARIQ
chk. by:	

drawing no.	W09-24
sheet	12 of 13



19 FRAME HEAD/SILL/JAMB/MULLION  
INTERIOR GLAZED

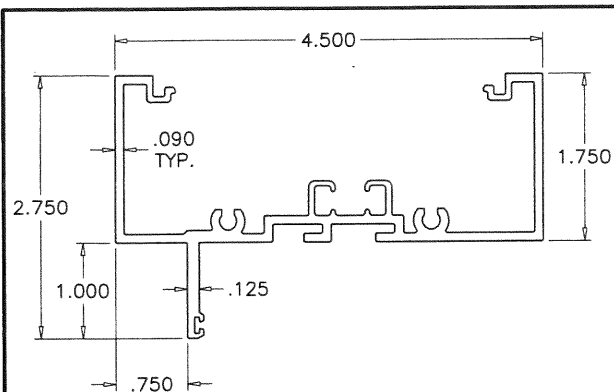

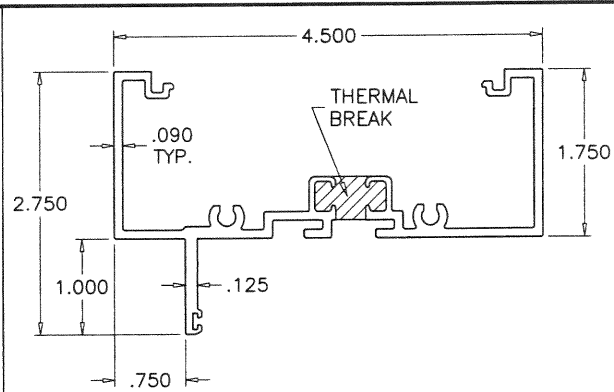
19A FRAME HEAD/SILL/JAMB/MULLION  
INTERIOR GLAZED (THERMAL)

THERMAL BREAK:  
FRAME MEMBERS FILLED AND DEBRIDGED USING  
'AZON SU312-19T' STRUCTURAL THERMAL BARRIER POLYMER  
MANUFACTURED BY 'AZON USA INC.'.

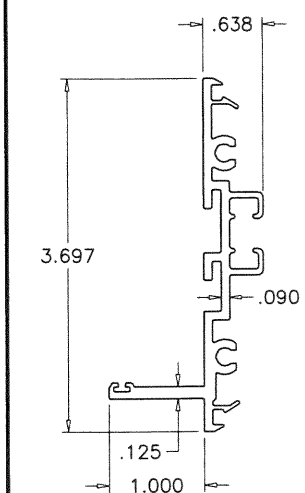

20 FIN SNAP  
INTERIOR GLAZED

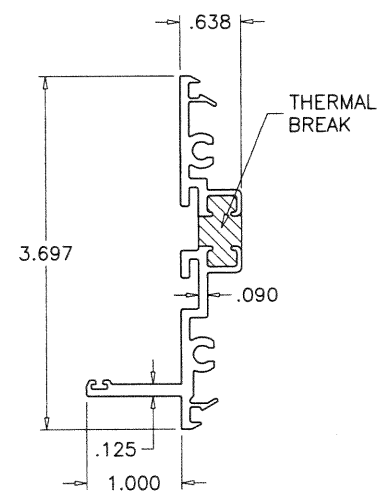

20A FIN SNAP  
INTERIOR GLAZED (THERMAL)

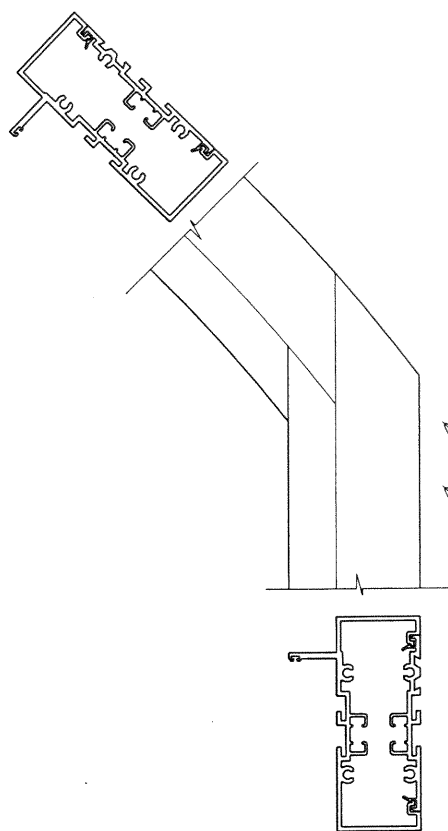

CORNER JOINT AT  
EYEBROW WINDOW

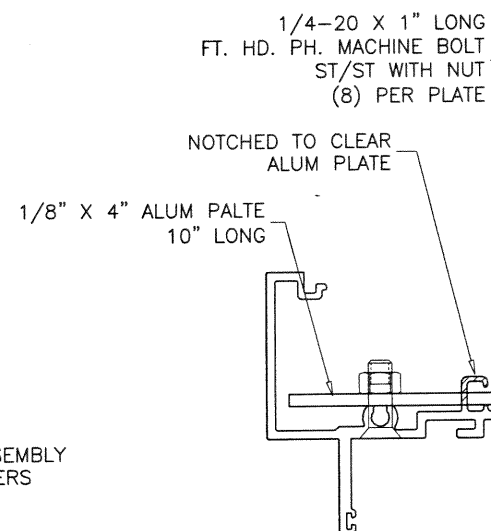

SPLICE JOINT AT  
HALF & FULL CIRCLE CORNERS

**PRODUCT REVISED**  
as complying with the Florida  
Building Code  
NOA-No. **20-0910.07**  
Expiration Date: **05/12/2025**  
By: *Manuel Perez*  
Miami-Dade Product Control

OCT 28 2020

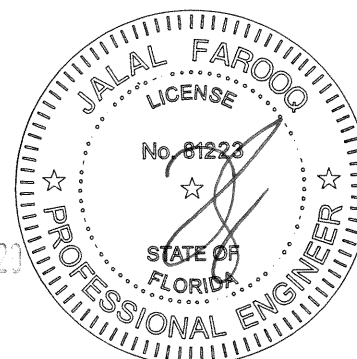

**AL-FAROOQ CORPORATION**  
ENGINEERS & PRODUCT DEVELOPMENT  
9360 SUNSET DRIVE, SUITE 220  
MIAMI, FLORIDA 33173 (C.A.N. 3538)  
TEL. (305) 264-8100 FAX. (305) 262-6978  
COMP-ANL\W09-24SM

SERIES SMI-090 ALUM WINDOW WALL (L.M.I.)  
**Aldora Aluminum & Glass Products Inc.**  
4250 Coral Ridge Drive, Suite 101  
Coral Springs, FL 33065  
Tel. (954) 784-6900 Fax. (954) 784-6901

revisions:		no	date	by	description
		E	01.11.17		GENERAL REVISION
		F	08.21.17		REV. PER RER COMMENTS
		G	06.25.20		UPDATED TO 2020 FBC

date: 04-16-09	scale: 1/2" = 1"	dr. by: TARIQ	chk. by:
----------------	------------------	---------------	----------

drawing no.  
**W09-24**  
sheet 12.1 of 13



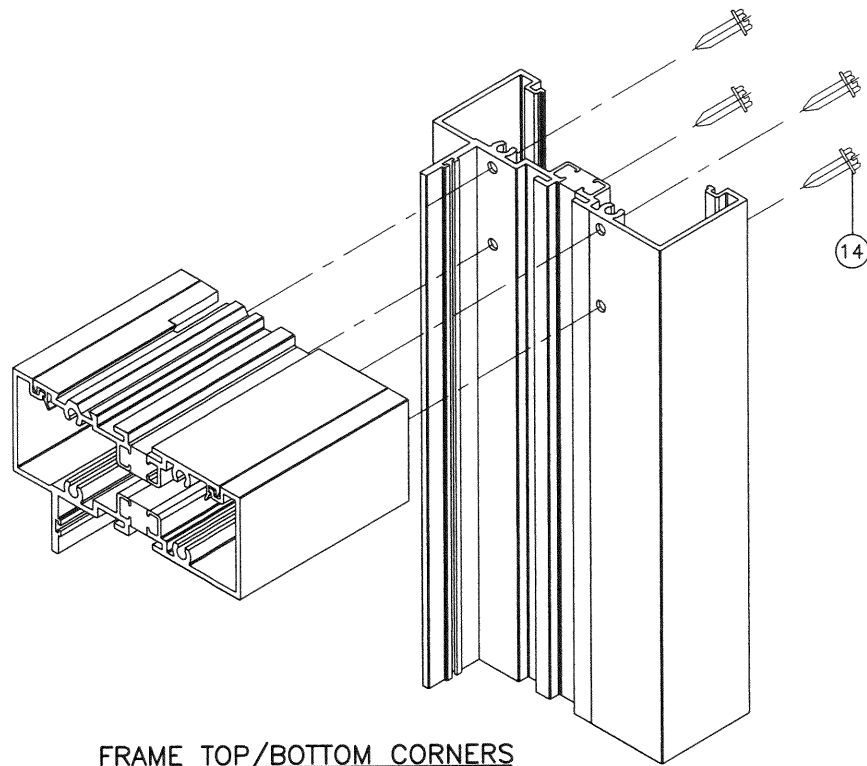

FRAME TOP/BOTTOM CORNERS

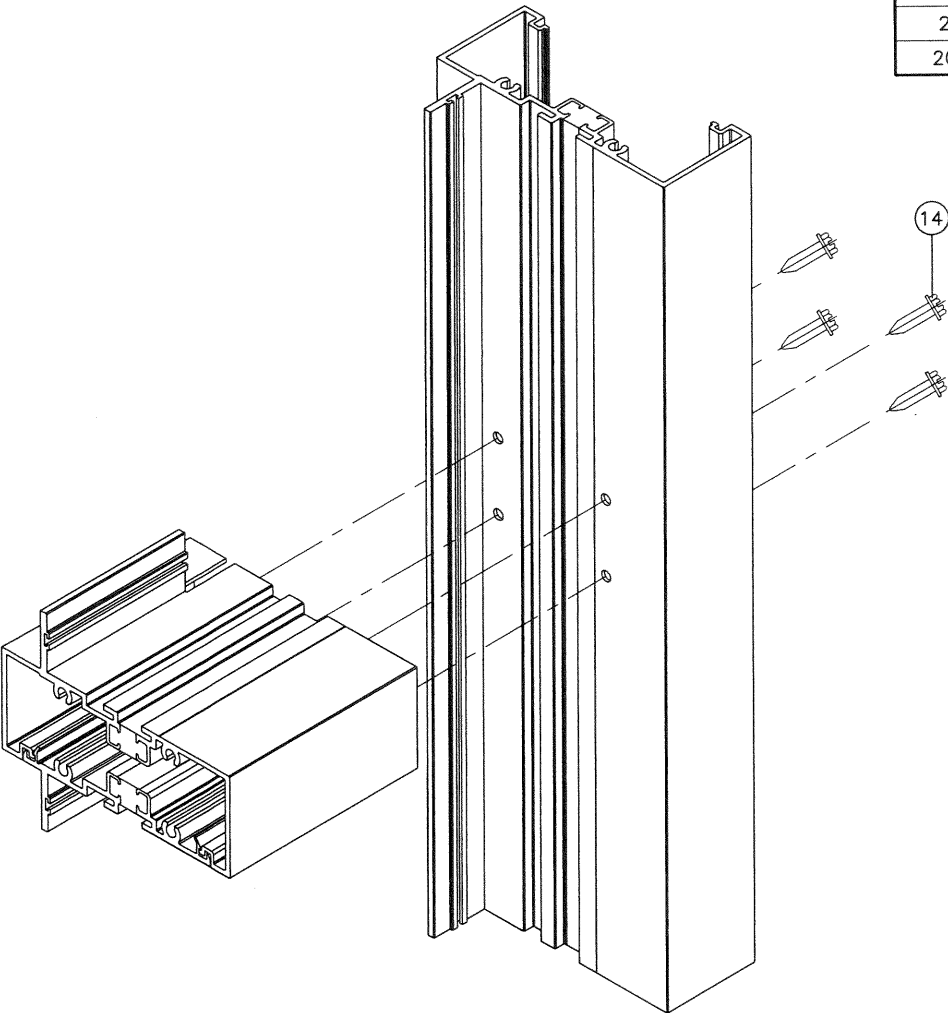

INTERMEDIATE HORIZONTAL CORNER

ITEM #	PART #	QUANTITY	DESCRIPTION	MATERIAL	MANF./SUPPLIER/REMARKS
1	SMI-091	AS REQD.	INT. GLAZED FRAME HEAD/SILL/JAMB/MULLION	6063-T6	-
1A	SMI-091T	AS REQD.	INT. GLAZED FRAME HEAD/SILL/JAMB/MULLION (POUR & DEBRIDGE)	6063-T6	-
2	SMI-098	AS REQD.	EXT. GLAZED FRAME HEAD/SILL/INTERM. HORIZ.	6063-T6	-
2A	SMI-098T	AS REQD.	EXT. GLAZED FRAME HEAD/SILL/INTERM. HORIZ. (POUR & DEBRIDGE)	6063-T6	-
3	SMI-094	AS REQD.	INT./EXT. GLAZED PLAIN SNAP	6063-T6	-
3A	SMI-094T	AS REQD.	INT./EXT. GLAZED PLAIN SNAP (POUR & DEBRIDGE)	6063-T6	-
4	SMI-093	AS REQD.	INT./EXT. GLAZED FIN SNAP	6063-T6	-
4A	SMI-093T	AS REQD.	INT./EXT. GLAZED FIN SNAP (POUR & DEBRIDGE)	6063-T6	-
5	SMI-095	AS REQD.	REINFORCING SPLICE	6005-T5	-
5A	SMI-P04	AS REQD.	THERMAL BRAKE SPACER FOR ALUM SPLICE	RIGID PVC	CENTRAL PLASTICS INC.
6	-	AS REQD.	REINFORCING BAR	STEEL	36 KSI MIN.
7	SMI-092	AS REQD.	INTERIOR GLASS STOP	6063-T6	-
8	SMI-097	AS REQD.	EXTERIOR GLASS STOP	6063-T6	-
9	SMI-G01	AS REQD.	INTERIOR GASKET (DUROMETER 70±5)	EPDM	GLAZING RUBBER PRODUCTS (#116)
10	SMI-G02	AS REQD.	SINGLE FACE TAPE (3/8" X 1/2")	VINYL FOAM	FRANK LOWE
11	SMI-G07	AS REQD.	EXTERIOR GASKET (DUROMETER 70±5)	EPDM	CENTRAL PLASTICS INC.
11A	SMI-G13	AS REQD.	SPACER / RETAINER OUTER GASKET	SANTOPRENE	MELTPPOINT PLASTICS INTERNATIONAL
12	SMI-SB06	2/ LITE	SETTING BLOCK LAM. GLASS (3/8" X 5/8" X 4" LG.) (DUROMETER 85±5)	EPDM	CENTRAL PLASTICS INC.
12A	SMI-SB04	2/ LITE	SETTING BLOCK LAM. INSUL. GLASS (3/8" X 1-1/4" X 4" LG.) (DUROMETER 85±5)	EPDM	CENTRAL PLASTICS INC.
14	#12 X 1-1/2"	4/ CORNER	FRAME ASSEMBLY SCREWS	ST. STEEL	HEX. HEAD MACHINE SCREWS
15	-	AS REQD.	REINFORCING CHANNEL (36 KSI MIN.)	STEEL	-
16	-	-	REINFORCING CHANNEL (DOOR MULLION)	STEEL	1" X 3-15/16" X 1" X 3/16" THK.
17	-	-	REINFORCING CHANNEL (DOOR MULLION)	STEEL	3/4" X 3-1/2" X 3/4" X 1/8" THK.
18	SMI-005	AS REQD.	DOOR MULLION	6063-T6	-
19	SMI-901	AS REQD.	INT. GLAZED FRAME HEAD/SILL/JAMB/MULLION	6063-T6	-
19A	SMI-901T	AS REQD.	INT. GLAZED FRAME HEAD/SILL/JAMB/MULLION (POUR & DEBRIDGE)	6063-T6	-
20	SMI-903	AS REQD.	INT. GLAZED FIN SNAP	6063-T6	-
20A	SMI-903T	AS REQD.	INT. GLAZED FIN SNAP (POUR & DEBRIDGE)	6063-T6	-

SEALANTS:

ALL FRAME CORNERS, JOINTS, MULLION SEAMS AND PERIMETER OF GLAZING BEAD TO FRAME SEALED WITH SILICONE SEALANT.

PRODUCT REVISED  
as complying with the Florida  
Building Code  
NOA-No. 20-0910.07  
Expiration Date: 05/12/2025  
By: Manuel Perez  
Miami-Dade Product Control

OCT 28 2020

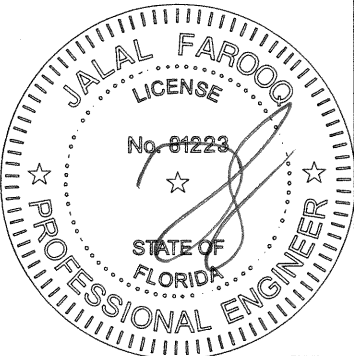

**a f c**

**AL-FAROOQ CORPORATION**  
ENGINEERS & PRODUCT DEVELOPMENT  
9360 SUNSET DRIVE, SUITE 220  
MIAMI, FLORIDA 33173  
TEL. (305) 264-8100 FAX. (305) 262-6978  
(C.A.N. 3538)

SERIES SMI-090 ALUM WINDOW WALL (L.M.I.)

**Aldora Aluminum & Glass Products Inc.**  
4250 Coral Ridge Drive, Suite 101  
Coral Springs, FL. 33065  
Tel. (954) 784-6900 Fax. (954) 784-6901

revisions:	no	date	by	description
	C	08.12.13		MANUF. NAME REV.
	D	03.05.14		NO CHANGE THIS SHEET
	E	01.11.17		GENERAL REVISION
	F	08.21.17		REV. PER PER COMMENTS
	G	06.25.20		UPDATED TO 2020 FBC

date: 04-16-09

scale: 1/2" = 1"

dr. by: TARIQ

chk. by:

drawing no.

**W09-24**

sheet 13 of 13

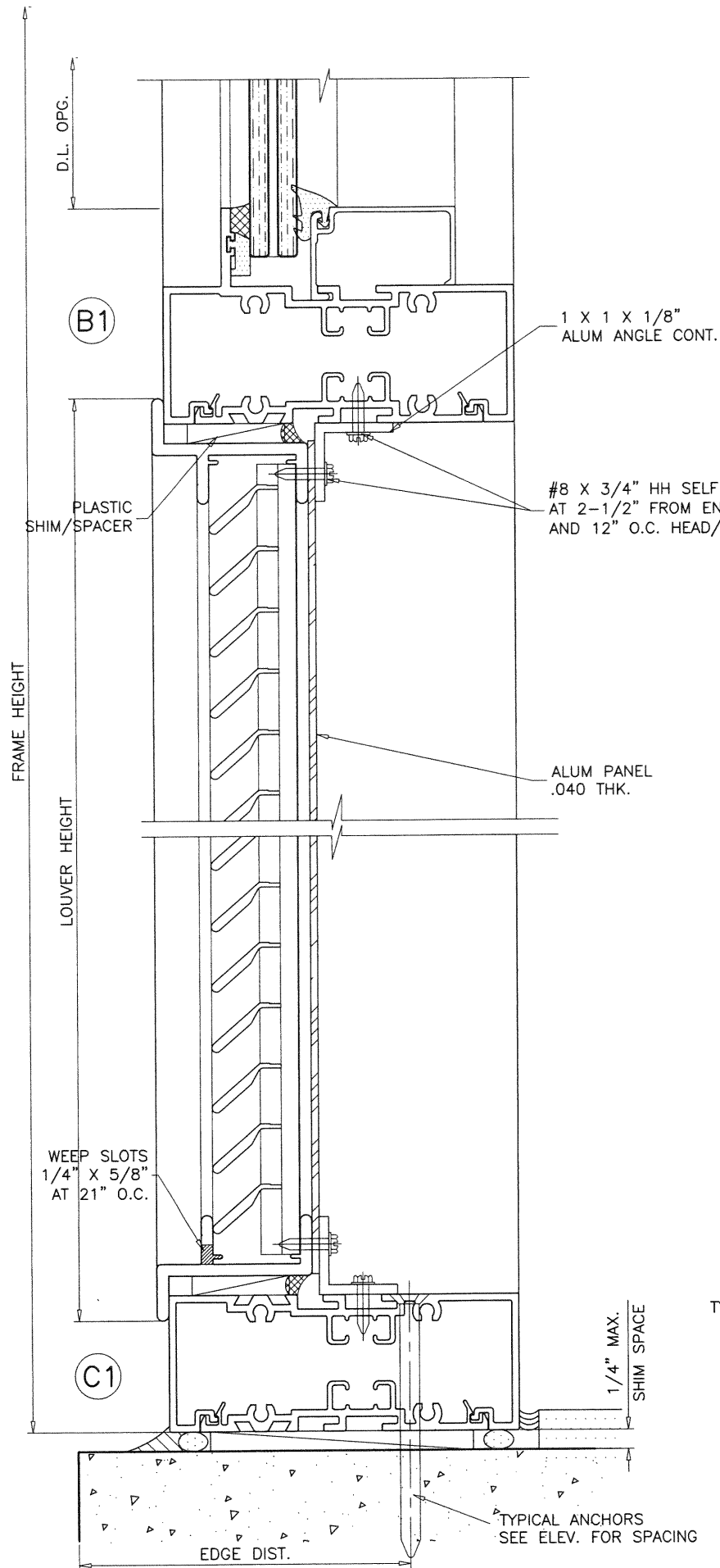

**PRODUCT REVISED**  
 as complying with the Florida  
 Building Code  
 NOA-No. **20-0910.07**  
 Expiration Date: **05/12/2025**  
 By: *Manuel Perez*  
 Miami-Dade Product Control

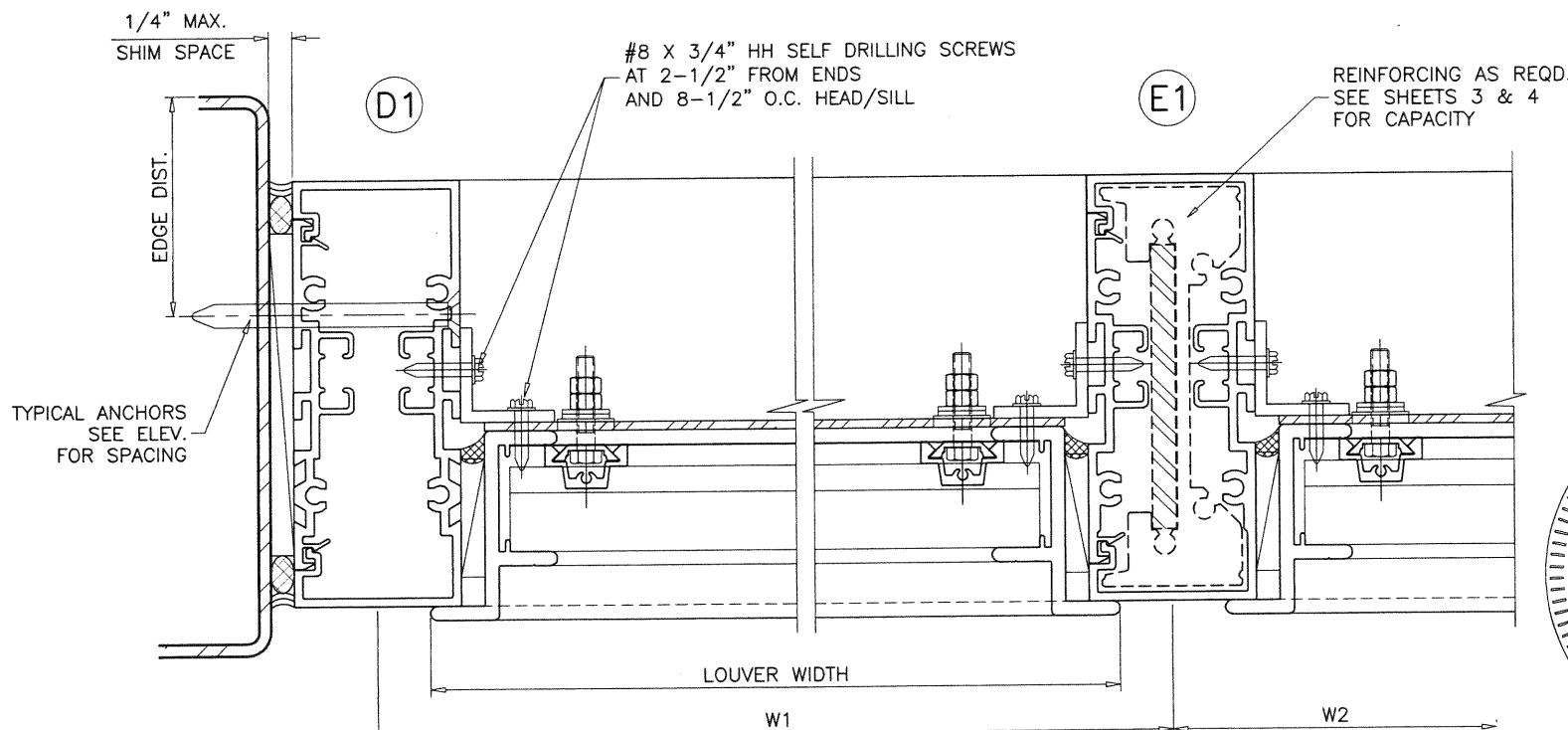

WIDTH (W) = W1  
 AT FRAME JAMB

WIDTH (W) =  $\frac{W2 + W3}{2}$   
 AT FRAME MULLION

FOR LOUVER FRAMES WITH INTERMEDIATE VERTICAL MULLIONS  
 REFER TO APPLICABLE CHARTS ON SHEETS 3 & 4.

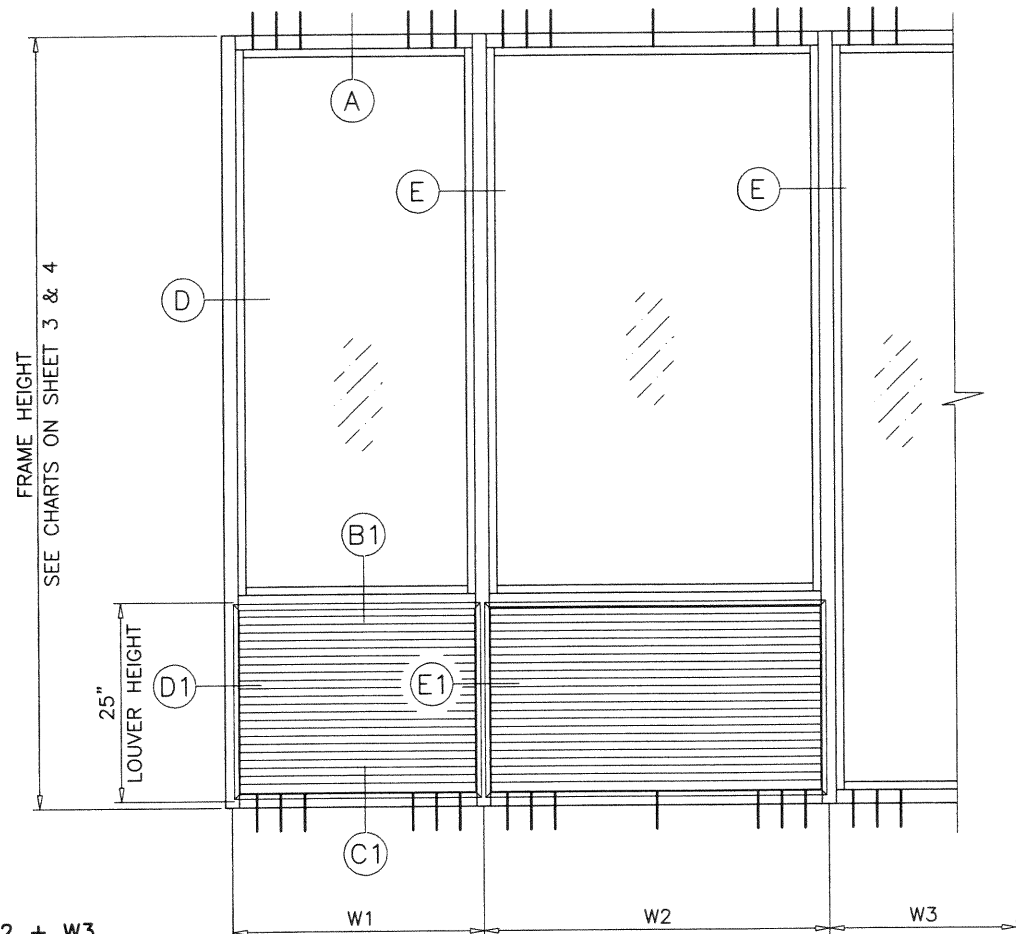

**TYPICAL INSTALLATION OF LOUVERS IN THE WINDOW WALL SYSTEM**  
 USE ALUMINUM LOUVERS HOLDING CURRENT NOA  
 DETAILS FOR 'RELIABLE PRODUCTS' APPROVED LOUVERS SHOWN

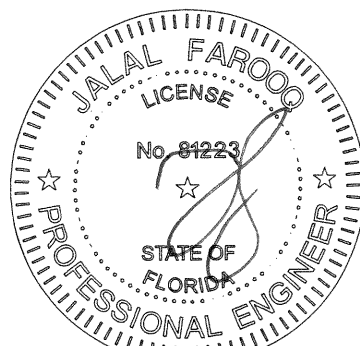

**AL-FAROOQ CORPORATION**  
 ENGINEERS & PRODUCT DEVELOPMENT  
 9360 SUNSET DRIVE, SUITE 220  
 MIAMI, FLORIDA 33173 (C.A.N. 3538)  
 TEL. (305) 264-8100 FAX. (305) 262-6978  
 COMP-ANL\W09-24SM

SERIES SMI-090 ALUM WINDOW WALL (L.M.I.)  
**Aldora Aluminum & Glass Products Inc.**  
 4250 Coral Ridge Drive, Suite 101  
 Coral Springs, FL 33065  
 Tel. (954) 784-6900 Fax. (954) 784-6901

no.	date	by	description
C	08.12.13		NEW SHEET ADDED
D	03.05.14		REV. PER RER COMMENTS
E	01.11.17		GENERAL REVISION
F	08.21.17		NO CHANGE THIS SHEET
G	06.25.20		UPDATED TO 2020 FBC

date: 04-16-09  
 scale: 1/2" = 1"  
 dr. by: TARIQ  
 chk. by:  
 drawing no. **W09-24**  
 sheet **13.1** of **13**



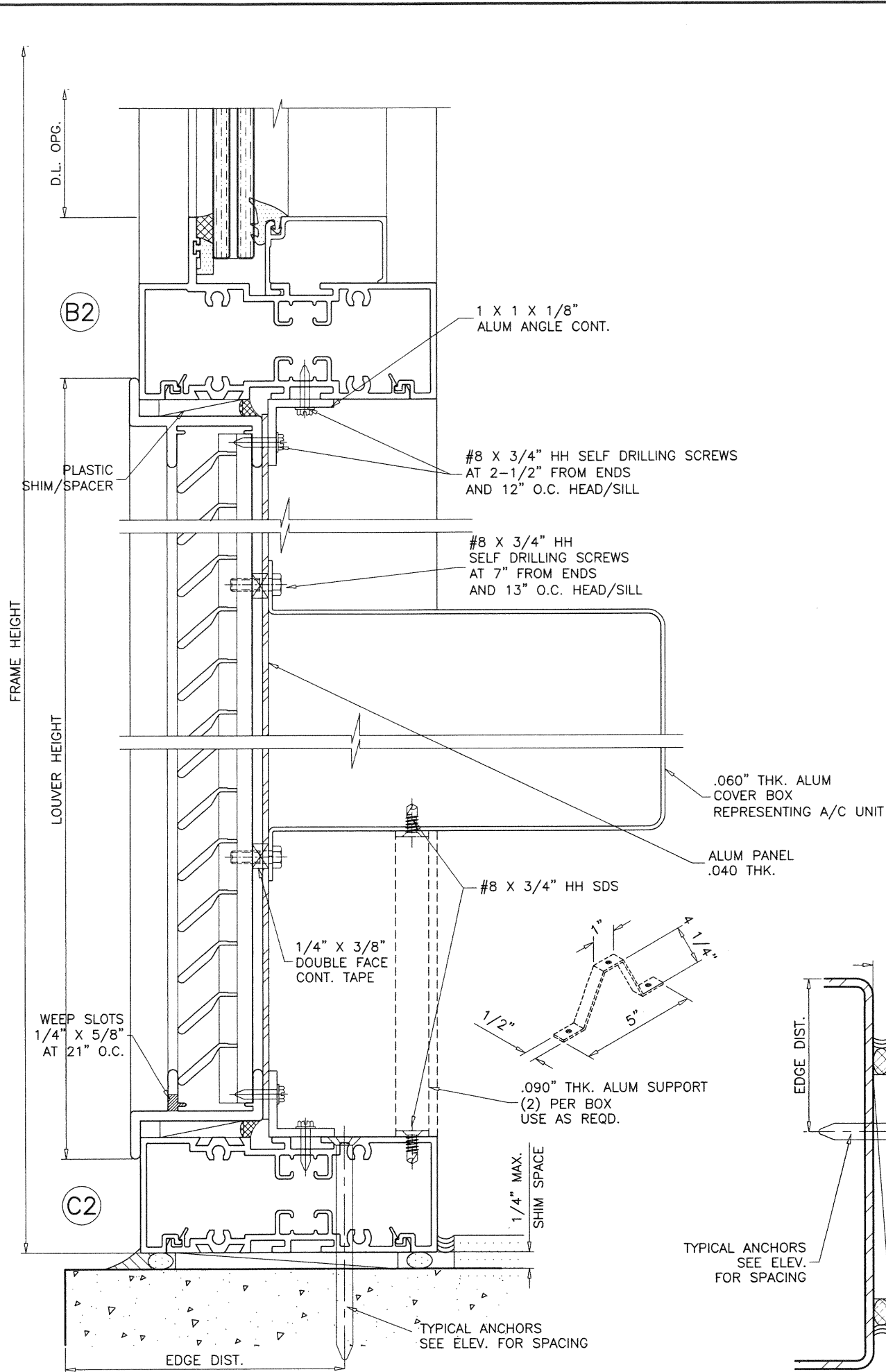

**PRODUCT REVISED**  
 as complying with the Florida  
 Building Code  
**NOA-No. 20-0910.07**  
**Expiration Date: 05/12/2025**  
 By: *Manuel Perez*  
**Miami-Dade Product Control**

**WINDOW WALL SYSTEM WITH LOUVERS TO ACCOMMODATE A/C UNIT**  
 USE ALUMINUM LOUVERS HOLDING CURRENT NOA  
 DETAILS FOR 'RELIABLE PRODUCTS' APPROVED LOUVERS SHOWN

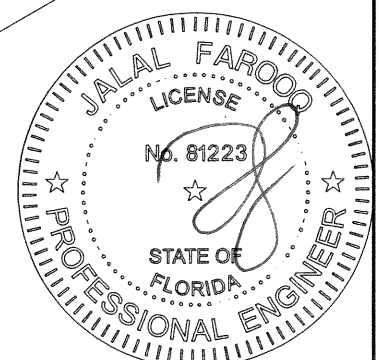
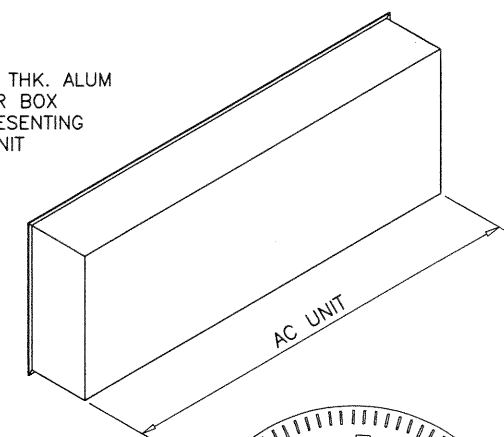
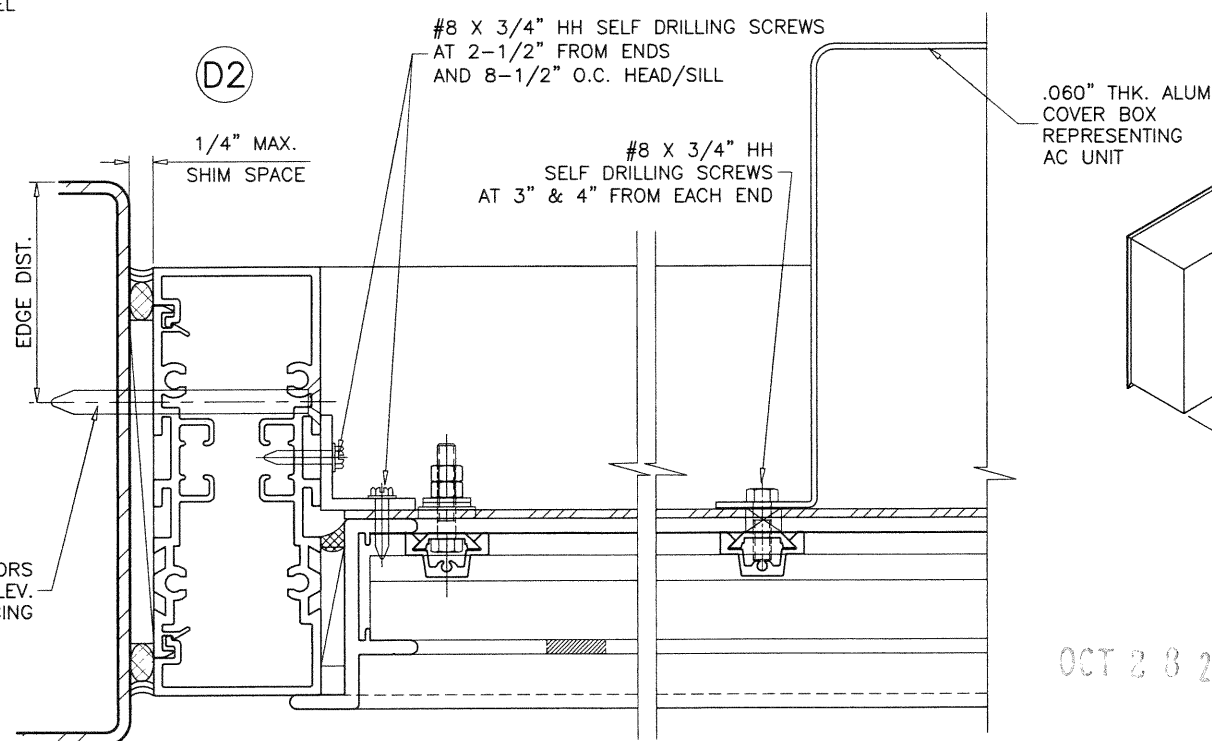

OCT 28 2020

**AL-FAROOQ CORPORATION**  
 ENGINEERS & PRODUCT DEVELOPMENT  
 9360 SUNSET DRIVE, SUITE 220  
 MIAMI, FLORIDA 33173 (C.A.N. 3538)  
 TEL. (305) 264-8100 FAX. (305) 262-6978  
 COMP-ANL\W09-24SM

SERIES SMI-090 ALUM WINDOW WALL (L.M.I.)

**Aldora Aluminum & Glass Products Inc.**  
 4250 Coral Ridge Drive, Suite 101  
 Coral Springs, FL 33065  
 Tel. (954) 784-6900 Fax. (954) 784-6901

no	date	by	description
C	08.12.13		NEW SHEET ADDED
D	03.05.14		REV. PER PER COMMENTS
E	01.11.17		GENERAL REVISION
F	08.21.17		NO CHANGE THIS SHEET
G	06.25.20		UPDATED TO 2020 FBC

date: 04-16-09

scale: 1/2" = 1"

dr. by: TARIQ

chk. by:

drawing no.  
**W09-24**

sheet **13.2** of **13**